



2021 PRODUCT GUIDE

PENNINGTON
& ASSOCIATES



TABLE OF CONTENTS

PAGE NO.

AIR RECEIVERS, HEAT EXCHANGERS, COMPRESSORS, DRYERS, BLOWERS			2-3
V A L V E S	SAFETY RELIEF, CHECK, PILOT, CONTROL		4-16
	LARGE INDUSTRIAL SAFETY		17
	BALL, GATE, SWING CHECK		18-21
AIR FILTERS			22-23
FILTERS, REGULATORS, LUBRICATORS, COMBO UNITS			24-27
SINTERED PRODUCTS			28-30
MOISTURE SEPARATORS, DRYERS, FLEXIBLE HOSE			31-35
CONDENSATE DRAINS			36-38
PRESSURE SWITCHES			39
GAUGES			40-43
AIR RECEIVER INSTALLATION			44-45
OIL/WATER SEPARATORS			46-47
DESICCANTS, CLEANERS			48
SAFETY VALVE & WATER CHARTS			49-51



Compressors



Blowers



Pumps



Accessories

Fuji Electric offers a wide range of Regenerative Blowers, High Pressure Blowers, Turbo Style Blowers, Coolant Pumps, Air Knife Systems and Vacuum Systems. Regenerative Blowers and High Pressure Blowers are used in applications that require powerful, high-performance blowers such as wastewater treatment plants and aquaculture applications. Air knife systems are often seen in Food Processing plants, while pneumatic vacuum systems play a vital role in a variety of applications, including medical and financial facilities.



For more than 60 years, Mattei rotary vane compressors have been used worldwide in nearly every industry and market. Open-frame, OEM, tank-mounted, belt- or direct-drive, and fully-enclosed cabinet units available.



Airend rebuilding and replacements for rotary screw compressors. Experts in fabrication and refurbishing, SCT utilizes proprietary techniques and designs and can fully restore any air end to like new condition. Also, shaft seal and air end rebuild kits. Over 28,000 other compressor parts in stock.



All dimensions & pipe sizes are in inches

Heated and heatless regenerative, refrigerated, blower purge, and custom air dryers.



Manchester Tank has served the needs of the compressed air industry with our standard product line and custom, built-to-order pressure vessels for decades. Our standard designs are constructed in accordance with ASME Section VIII Division I Coded latest edition and are registered with the National Board of Boiler and Pressure Vessel Inspectors.

Vacuum Receivers, Vertical Air Receivers 10-5000 Gallons
Horizontal Air Receivers 1-2560 Gallons

Epoxy Lined Water Tanks 140-535 Gallons
Horizontal Grasshopper Tank 120 Gallons
Horizontal Gas Driven Tank 30 Gallons



Precision engineered, high performing heat exchanger components and assemblies for Compressed Air, Fluid Power, and Engine



Phone: 727-535-3200
Fax: 727-533-9696

www.penningtonassociates.com
email: sales@penningtonassociates.com

Sales office hours:
8 AM to 5 PM Eastern

ASME SOFT SEAT SAFETY RELIEF VALVES



CDI p/n	Conrader p/n	Thread NPT	List price (\$)	1-49	50-99	100+
ST2512-*	SRV250-1/8-*	1/8	8.15	4.40	3.83	3.50
ST25-*	SRV250-1/4-*	1/4				
ST2533-*	SRV250-3/8-*	3/8	8.15	4.40	3.83	3.50

* To order, please specify thread and set pressure (ex. SRV250-1/4-150 = 1/4" NPT safety valve set @ 150 psig). BSPT sizes also available.

For small compressor systems and related applications. High flow capacities in a compact size (see chart, p. 50). A resilient seal insures valve is bubble tight to within 10% of set pressure. All brass construction. Stamped with "UV" and "NB" symbols. Hex size: 11/16 Weight: 1.6 oz, Max. temp: 250°F.

ST25 series: Zinc-plated music wire spring. Set pressure range: 25 - 350 psig, tolerance: $\pm 3\%$. Overall length: 1.99

SRV250 series: Stainless steel spring. Set pressure range: 25 - 450 psig, tolerance: ± 2 psig @ ≤ 70 psig, $\pm 3\%$ @ > 70 psig. Overall length: 1.75



CDI p/n	Conrader p/n	List price (\$)	1-49	50-99	100+
SF50-*	SRV390-*	22.15	11.96	10.41	9.52

* To order, please specify thread and set pressure (ex. SRV390-3/8-150 = 3/8" NPT safety valve set @ 150 psig). BSPT sizes also available.

For systems requiring standard flow capacities (see chart, p. 50). A resilient seal insures valve is bubble tight to within 10% of set pressure. All brass construction. Stamped with "UV" and "NB" symbols. Hex size: 7/8 Weight: 4.5 oz.

SF50 series: Zinc-plated music wire spring. Set pressure range: 50 - 250 psig, tolerance: $\pm 3\%$. O/A length: 3.36 Max. temp: 250°F.

SRV390 series: Stainless steel spring. Set pressure range: 25 - 300 psig, tolerance: ± 2 psig @ ≤ 70 psig, $\pm 3\%$ @ > 70 psig. O/A length: 2.69 Max. temp: 400°F.



CDI p/n	Conrader p/n	Thread NPT	Wt (oz)	List price (\$)	1-49	50-99	100+
SB50-*	SRV530-12-*	1/2	8.0	62.95	33.99	29.59	27.07
SB75-*	SRV530-34-*	3/4	9.6	62.95	33.99	29.59	27.07

* To order, please specify thread and set pressure (ex. SRV530-3/8-150 = 3/8" NPT safety valve set @ 150 psig). BSPT sizes also available.

For greater flow capacities (see chart, p. 50). Unique o-ring seal insures valve is bubble tight to within 10% of set pressure. All brass construction. Stamped with "UV" and "NB" symbols. Height: 3.59 Hex size: 1-1/16

SB series: Stainless steel spring. Set pressure range: 25 - 300 psig, tolerance: $\pm 3\%$. Max. temp: 250°F.

SRV530 series: Set pressure range: 25 - 250 psig. Thread sizes from 1/8 to 1 NPT as well as BSPT available.



ASME SOFT SEAT SAFETY RELIEF VALVES

CDI p/n	Conrader p/n	Thread NPT	Wt (lbs)	List price (\$)	1-49	50-99	100+
SW10-*	SRV765-*	1	1.7	84.90	45.85	39.90	36.51
SW12-*	SRV765-114-*	1-1/4	1.9	87.68	47.35	41.21	37.70



* To order, please specify set pressure (ex. SRV765-150 = 1" NPT safety valve set @ 150 psig). BSPT sizes also available.

For large flow capacities (see chart, p. 50). Hex size: 1-5/8 Overall height: 4.49 Stamped with "UV" and "NB" symbols.

SW series: Unique O-ring seal insures valve is bubble tight to within 10% of set pressure. All brass construction with stainless steel spring. Set pressure range: 25 - 250 psig; tolerance $\pm 3\%$. Max. temp: 250°F.

SRV765 series: Set pressure range: 25 - 300 psig. Max. temp: 400°F.

CDI p/n	Conrader p/n	Thread NPT	List price (\$)	1-49	50-99	100+
SP12-*	SRV187-*	1/8	6.85	3.70	3.22	2.95
SP25-*	SRV187-14-*-SST	1/4				



* To order, please specify set pressure (ex. SRV187-14-150-SST = 1/4" NPT safety valve set @ 150 psig). BSPT sizes also available.

Used where a compact size is required together with high flow capacities (see chart, p. 50). All brass construction with stainless steel spring. Stamped "UV" and "NB". Set pressures: 75, 125, 135, 150, and 200 psig only. Overall height: 1.50 Hex size: 9/16

SP series: Resilient Viton[®] rubber pad insures valve is bubble tight to within 10% of set pressure. Set pressure tolerance: $\pm 3\%$ Max. temp: 250°F. Weight: 1.0 oz

SRV187 series: Set pressure tolerance: ± 2 psig @ ≤ 70 psig, $\pm 3\%$ @ > 70 psig. Max. temp: 400°F.

CDI p/n	Thread NPT	Hex size	List price (\$)	1-49	50-99	100+
SCB5075-*	1/2	1-7/16	139.15	75.14	65.40	59.83
SCB7510-*	3/4	1-3/8				



* To order, please specify set pressure (ex. SCB5075-150, safety valve set @ 150 psig).

SCB series: Side vent valves are designed for large flow capacities (see chart, p. 50). Unique O-ring seal insures valve is bubble tight to within 10% of set pressure. All brass construction with stainless steel springs. Stamped with "UV" and "NB" symbols. Set pressure range: 50 - 300 psig, tolerance $\pm 3\%$. Max. temp: 300°F. Weight: 1.5 lbs. Overall height: 4.53

ASME HARD SEAT SAFETY RELIEF VALVES

CDI p/n	Conrader p/n	Thread NPT	List price (\$)	1-49	50-99	100+
SA12-*	SRH250-18-*-SST	1/8	12.20	6.59	5.73	5.25
SA25-*	SRH250-*-SST	1/4	12.25	6.62	5.76	5.27
SA38-*	SRH25038-*-SST	3/8	26.60	14.36	12.50	11.44

* To order, please specify set pressure (ex. SRH250-18-150-SST = 1/8" NPT safety valve set @ 150 psig). BSPT sizes also available.



SA and SRH250 series: Designed for higher temperature applications such as intercoolers and aftercoolers. All brass construction with 17-7PH stainless steel sealing ball on brass seat. Stamped with "UV" and "NB" symbols. Set pressure range: 50 - 350 psig; tolerance $\pm 3\%$ Max. temp.: 350°F Overall height: 2-1/8 Hex size: 11/16 Weight: 2.5 oz

CDI p/n	Conrader p/n	List price (\$)	Thread NPT	1-49	50-99	100+
SN50-*	SRH375-*-SST	26.60	1/2	14.36	12.50	11.44

* To order, please specify set pressure and thread size (ex. SRH375-150-SST = 1/2" NPT safety valve set @ 150 psig). BSPT sizes also available.



All brass construction with stainless steel sealing ball on brass seat. Stamped with "UV" and "NB" symbols. Set pressure range: 50 - 350 psig Hex size: 7/8 Weight: 6.5 oz Overall height: 3.5
SN series: Max. temp: 350°F
SRH375 series: Max. temp: 400°F Set pressure tolerance: ± 2 psig @ ≤ 70 psig, $\pm 3\%$ @ > 70 psig.

NON-CODE SAFETY RELIEF VALVES

CDI p/n	Conrader p/n	Set pressure (adjusting range, psi)	List price (\$)	1-49	50-99	100+
NC25-001	CNC25-25-50	25 - 50	9.00	4.86	4.23	3.87
NC25-002	CNC25-51-100	51 - 100				
NC25-003	CNC25-101-150	101 - 150				
NC25-004	CNC25-151-200	151 - 200				
NC25-Kit	N/A	1 valve & 4 spring asst.	11.15	6.02	5.24	4.79



NC and CNC series: Non-code safety valves are field adjustable. Knurled thumbscrew and jam nut make adjustments easy and repeatable. Valves can be supplied unset, or factory set and locked with jam nut, or factory set and staked (to deter field adjustment). 1/4" NPT inlet. All brass construction with stainless steel spring and silicone rubber seal. Available set pressure range: 25 - 200 psig Max. temp. 250°F Overall height: 1-5/8 Hex size: 9/16 Weight: 1.1 oz



PRESSURE RELIEF VALVES



CDI p/n	NPT	Available cracking pressure range (psig)	List price (\$)	1-49	50-99	100+
PR25-020	1/4	0-20	13.50	7.29	6.35	5.81
PR25-1060	1/4	10-60				
PR25-50125	1/4	50-125				
PR25-100200	1/4	100-200				
PR38-020	3/8	0-20	16.95	9.15	7.97	7.29
PR75-020	3/4	0-20	25.75	13.91	12.10	11.07

PR Series: Pressure relief valves are used in systems to maintain a desired pressure level. Please note that they are proportional relief valves and not "pop"-type safety valves. Not preset at the factory, but easily field adjusted with knurled adjustment screw and locked with jam nut. All brass construction with stainless steel springs. PR25 uses a stainless steel ball for the poppet; PR38 and PR75 poppets are nylon with nitrile seals. Max. Temp. 250°F.

SUPER-CHEK® IN-TANK CHECK VALVES

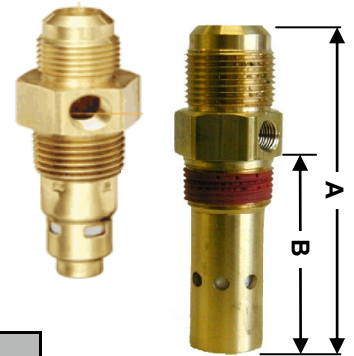

MALE JIC INLET & MALE PIPE OUTLET THREADS

CDI p/n	Conrader p/n	Inlet	Outlet	Dim A	Dim B	List price (\$)	1-49	50-99	100+
F5050-1EA	CTF1212-SST	1/2	1/2	2-7/8	1-1/2	16.45	8.88	7.73	7.07
F7575-1EA	CTF3434-SST	3/4	1/2	3-9/16	2-3/8	37.60	20.30	17.67	16.17

F series Super-Chek® : This design has proven over the last 15 years to be the standard for air compressor in-tank check valves. One-piece brass bodies, stainless steel springs, and glass-filled fluoropolymer poppets all add up to long term reliability. Inlet is male JIC flare fitting; outlet is male NPT. The eight discharge holes insure quiet operation. Valves may be disassembled for cleaning or repair, and are 100% tested for backflow leakage performance. Max. pressure: 450 psig Max. temp: 450°F Hex size: 7/8 Weight: 3.5 oz Max flow rate: 20 scfm

SUPER-CHEK[®] IN-TANK CHECK VALVES

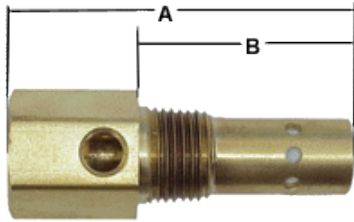

One-piece C360 brass bodies, 302 stainless steel springs, and glass-filled Teflon[®] poppets all add up to long term reliability. Valves may be disassembled, and are 100% tested for backflow leakage performance. Max. pressure: 500 psi, Max. temp.: 450°F

FEMALE INLET AND MALE OUTLET PIPE THREADS

CDI p/n	Conrader p/n	Inlet size	Outlet size	Hex size	Dim A	Dim B	Max flow rate (scfm)	Wt (oz)	List price (\$)	1-49	50-99	100+
N/A	CTLB3838	3/8	3/8	3/4	2-5/8	1-5/8	12	2.7	14.50	7.83	6.82	6.24
P3850T	CTLB3812-SST	3/8	1/2	7/8	2-3/4	1-7/8	20	3.8	14.50	7.83	6.82	6.24
P5050T	CTLB1212-SST	1/2	1/2	1	3	1-7/8	20	5.5				
P5075T	CTLB1234-SST	1/2	3/4	1-1/8	3-1/2	2-1/2	30	6.5	30.65	16.55	14.41	13.18
P7575T	CTLB3434-SST	3/4	3/4	1-3/16	3-1/4	2-1/4	30	7.2	20.40	11.02	9.59	8.77
P7510T	CTLB341-SST	3/4	1	1-5/16	3-1/2	2-1/2	60	11.4	30.85	16.66	14.50	13.27
P7515T	CTLB34112-SST	3/4	1-1/2	2-1/4	4-1/2	3-1/2	150	24	165.85	89.56	77.95	71.32
P1010T	CTLB11-SST	1	1	1-1/2	3-7/8	2-5/8	60	12.5	52.85	28.54	24.84	22.73
P1212T	CTLB114114-SST	1-1/4	1-1/4	1-7/8	4-7/16	3-1/4	130	17.5	95.60	51.62	44.93	41.11
P1515T	CTLB112112-SST	1-1/2	1-1/2	2-1/4	4-1/2	3-1/2	150	30	183.00	98.82	86.01	78.69

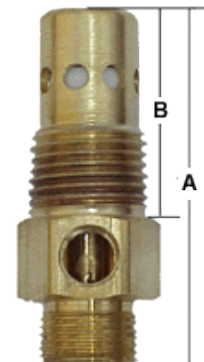

COMPRESSION FITTING INLET AND MALE PIPE OUTLET THREADS

CDI p/n	Conrader p/n	Inlet size	Outlet size	Hex size	Dim A	Dim B	Max flow rate (scfm)	Wt (oz)	List price (\$)	1-49	50-99	100+
C3850T	CTLD3812-SST	3/8	1/2	7/8	2-7/8	1-7/8	20	4.2	19.60	10.58	9.21	8.43
C5038T	N/A	1/2	3/8	11/16	2-1/4	1-3/16	12	1.5	19.10	10.31	8.98	8.21
C5050T	CTLD1212-SST	1/2	1/2	7/8	2-7/8	1-7/8	20	4.2	14.85	8.02	6.98	6.39
N/A	CTLD3412-SST	3/4	1/2	7/8	2-7/8	1-7/8	20	4.2	19.60	10.58	9.21	8.43
C7575T	CTLD3434-SST	3/4	3/4	1-1/8	3-1/2	2-3/8	30	7.4	20.65	11.15	9.71	8.88
C7510T	CTLD341-SST	3/4	1	1-5/16	3-3/4	2-5/8	60	11.5	38.30	20.68	18.00	16.47



AUXILIARY UNLOADER (COLD START)

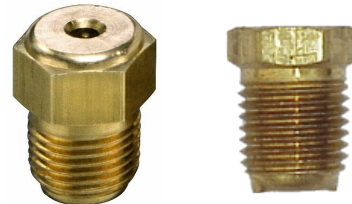

CDI p/n	Conrader p/n	Thread NPT	List price (\$)	1-49	50-99	100+
CS12	SU3	1/8	5.22	2.82	2.45	2.24
CS25	SU3-14	1/4	4.95	2.67	2.33	2.13

CS12 & CS25 series: Unloads heads during start-up. Valves bleed air from the compressor head during the first few pump revolutions, thus reducing motor starting torque requirement. These valves are especially helpful on oil-lubed pumps that may be subject to low temperatures and low starting voltages, such as a contractor unit that may sit outside overnight and be connected to a long extension cord. The **CS** valve is installed into any convenient port upstream of the tank check valve. Typical installations are into a 1/8" NPT port in the check valve (CDI in-tank check valves are available with the **CS12** installed as an option), into a port tapped in the head of the pump, or into a "tee" in the discharge line. With the discharge line at zero pressure, the **CS** valve is open, and as the pump starts, air flows out the **CS** valve to atmosphere. As pump speed and discharge pressure increase, the valve snaps shut and stays closed until the end of the pump-up cycle. When unloaded (a pressure switch unloader or similar device is still required), the **CS** valve re-opens, and is ready for the next start up. Body and piston are brass, with a stainless steel spring and fluorocarbon o-ring.

LOAD GENIE®

UNLOADING CHECK VALVE

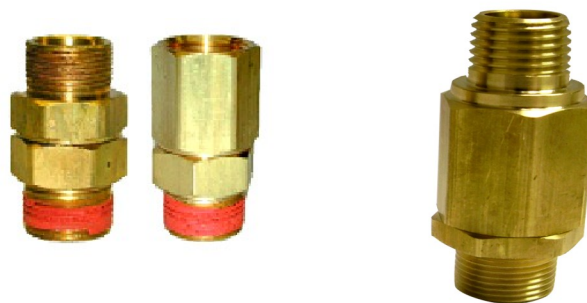

CDI p/n	Conrader p/n	Inlet	Outlet (MPT)	Min & Max flow (scfm)	Hex size	List price (\$)	1-49	50-99	100+
CA-6	UNCVC6	3/8 TUBE	1/4	1 to 6	3/4	23.90	12.91	11.23	10.28
CA-12	UNCVC12	1/2 TUBE	3/8	3 to 12	13/16	26.75	14.45	12.57	11.50
CA-24	UNCVC24	3/4 TUBE	1/2	8 to 24	1	44.35	23.95	20.84	19.07
CA-48	UNCVC48	3/4 TUBE	3/4	15 to 48	1-13/16	50.00	27.00	23.50	21.50
PA-6	UNCVP6	1/4 FPT	1/4	1 to 6	3/4	24.95	13.47	11.73	10.73
PA-12	UNCVP12	3/8 FPT	3/8	3 to 12	13/16	29.15	15.74	13.70	12.53
PA-24	UNCVP24	1/2 FPT	1/2	8 to 24	1	38.00	20.52	17.86	16.34
PA-48	UNCVP48	3/4 FPT	3/4	15 to 48	1-13/16	58.75	31.73	27.61	25.26

Unloads heads during start-up. A compressor running in a "start/stop" mode operates more efficiently if the pressure trapped in the compressor head and discharge line is released after each pump-up cycle. This allows for a smoother start and the use of a motor with lower starting torque. The most convenient way to release this trapped pressure is to use the CDI Load Genie® combination check and unloader valve.

The Load Genie® senses air flow when the compressor is running and closes an unloading orifice port. When airflow stops (ex: when the pressure switch turns the motor off), the Load Genie® opens the unloading orifice to release head pressure, and a built-in check valve keeps receiver air from leaking back into the discharge line and compressor head.

Alternative methods rely on external un-loading valves mounted on the pressure switch or compressor. The external un-loading valves are connected with the appropriate tubing and fittings to the compressor discharge line or compressor head. A tank check valve is also required. The system, then, consists of the unloading valve, connecting tubing, appropriate fittings, and the tank check valve. Size the Load Genie® towards the maximum end of the rated flow range. Max. pressure 250 PSI.

CARRY TANK MANIFOLDS



CDI p/n	Inlet, male	Outlet, female	Gauge port, female	Hex size	Height	Wt (oz)	List price (\$)	1-49	50-99	100+
CTM-150	1/2 MPT	1/4 NPT	1/8 NPT	7/8	1.84	4.8	16.95	9.15	7.97	7.29

These carry tank manifolds incorporate a tank filler valve into the built-in shut off valve. The filler valve mates to a typical tire chuck for easy tank pressurization. The integral non-code safety valve is factory preset at 150 psi. Also included is a tank pressure gauge port. Solid brass body and components with stainless steel springs, nitrile O-rings, and silicone rubber safety valve seals.

AIR COMPRESSOR MANIFOLDS



CDI p/n	Conrader p/n	Inlet, male	Outlet, female	Gauge port, female	Hex size	Height	Wt (oz)	List price (\$)	1-49	50-99	100+
ACM-150	MANIFOLD-5590-150	1/2 MPT	1/4 NPT	1/4 NPT	7/8	1.84	4.8	21.85	11.80	10.27	9.40

Features a built-in shut off valve and a non-code safety valve. A pressure switch mount and a tank pressure gauge port allow all control and outlet functions to be connected to the 1/2 NPT tank port. Flow capacity of outlet valve and safety valve make this manifold suitable for compressors of 3 HP and smaller. Relief pressure setting is 150 psi.

IN-LINE PISTON CHECK



CDI p/n	Conrader p/n	Inlet	Outlet	Hex size	Max flow rate (scfm)	Wt (oz)	List price (\$)	1-49	50-99	100+
M25M25	CLS14-SST	1/4 MPT	1/4 MPT	9/16	9	1.0	17.15	9.26	8.06	7.37
P2525	CLSF14-SST	1/4 FPT	1/4 MPT	11/16	9	1.5	11.09	5.99	5.21	4.77

These in-line piston checks offer bubble-tight sealing capabilities at low pressure drops. They can be used as tank check valves for small compressors or as components in pneumatic circuits. Valve bodies and pistons are brass with fluorocarbon o-rings and stainless steel springs. Max. pressure: 250 psi Max. temp. 250°F Available in a variety of inlet/outlet configurations and orifice

IN-LINE CHECK VALVES



CDI p/n	Conrader p/n	Thread size, FPT	Dimensions			Max flow rate (scfm)	Weight		List price (\$)	1-49	50-99	100+
			Length	Height	Width							
CB08	GV18	1/8	1-3/4	1-5/8	27/32	12	6.0	(oz)	16.15	8.72	7.59	6.94
CB25	GV14	1/4	1-3/4	1-5/8	27/32	12	6.0		23.96	12.95	11.26	10.30
CB33	GV38	3/8	2-3/16	1-7/8	1-7/8	22	9.0		28.75	15.53	13.51	12.36
CB50	GV12	1/2	2-1/2	2-1/8	2-1/8	38	13.0		38.50	20.79	18.10	16.56
CB75	GV34	3/4	2-7/8	2-1/2	2-1/2	60	1.25	(lb)	65.35	35.29	30.71	28.10
CB10	GV1	1	3-1/2	2-7/8	2-1/8	115	1.75		118.75	64.13	55.81	51.06
CB12	GV114	1-1/4	3-7/8"	3-1/8	2-1/4	160	2.50		149.90	80.95	70.45	64.46
CB15	GV112	1-1/2	4-1/8	3-7/16	2-1/4	160	2.75		162.75	87.89	76.49	69.98
CB20	GV2	2	4-1/2	3-7/8	2-3/4	220	3.75		298.70	161.30	140.39	128.44

These check valves have been specifically designed for installation into air compressor discharge lines. Extra-heavy walled cast brass bodies, glass-filled fluoropolymer poppets, and stainless steel springs resist corrosion and insure long life. Plugged 1/8" NTP unloader port is standard. Max. pressure: 250 psi Max. temp: 450°F



CDI p/n	Conrader p/n	FNPT in/out	Hex size	Length	Max flow rate (scfm)	Weight (oz)	List price (\$)	1-49	50-99	100+
IC25	CLB14	1/4 NO TAP	11/16	2.13	12	4.5	14.40	7.78	6.77	6.19
IC38	CLB38	3/8 FPT	13/16	2.70	12	5.0	22.80	12.31	10.72	9.80
IC50	CLB12	1/2 FPT	1	2.82	20	7.0	26.90	14.53	12.64	11.57
IC75	CLB34-RF	3/4 FPT	1-1/4	3.50	30	13.0	42.40	22.90	19.93	18.23

CDI IC in-line check valves were created around the Super-Chek® design. For those compressor applications where an in-tank valve will not fit, an IC valve can conveniently be installed right in the discharge line of the compressor. Brass bodies, glass-filled fluoropolymer poppets, and stainless steel springs insure long life. A plugged 1/8" NTP unloader port is standard. Max. pressure: 450 psi Max. temp: 400°F

VENT UNLOADER AND PILOTED DISCHARGE VALVES



LGM20



LGM30



LGM40



Conrader

CDI p/n	Conrader p/n (see table next page)	Inlet & outlet size (FNPT)	Vent outlet size (FNPT)	Max flow rate (scfm)	Wt (lbs)	List price (\$)	1-49	50-99	100+
LGM-20T	NG-1-N	1/2	3/8	20	1.75	100.25	54.14	47.12	43.11
LGM-125-AEF		1-1/4	1	125	6.25	752.60	406.40	353.72	323.62
LGM30-*	NSG-*	See table		30	1.1	76.35	41.23	35.88	32.83
LGM40- *	NG- *	See table		30	1.6	93.15	50.30	43.78	40.05

The **LGM series** is a self-contained unloading valve which can be used wherever a continuous run compressor is required. The compressor may need to run continuously because the air demanded is close to the maximum output of the compressor, or because the compressor is driven by a gasoline or diesel engine. Since these valves are "vent" unloaders, built-in head unloaders are not required on the compressor. They incorporate all components required - pilot valve, vent valve, and check valve. Simply install the valve in the discharge line between the compressor and receiver. Valve cut-in and cut-out pressures are factory set per customer specifications. If no settings are specified, the valve is set at a standard setting of 115 psi cut-out and 95 psi cut-in. Minimum cut-out pressure is 60 psi, and maximum cut-out pressure is 250 psi. Valves are also field adjustable. Options include a 1/8" NPT tapped port for throttle control of a gas engine, a lockout clip for "dual control" applications, a special 1/8" NPT tapped port for a pressure switch unloader valve, a vent port muffler, and a toggle unloading lever for one-hand warm up control.

For LGM30 & 40 only		Choose one each inlet and outlet style			
Select a configuration:		Inlet style	Code	Outlet style	Code
LGM40A = straight inlet		1/2" compression	03	1/2 external NPT	01
		1/2" internal NPT	04	With Vibra-Seal®	02
LGM40C = right-angle inlet		5/8" compression	06	1/2 internal NPT	04
		3/4" compression	07	1/4 internal NPT	14
<u>Example:</u> LGM40A-0304 = straight inlet with 1/2" compression inlet and 1/2" internal NPT outlet		5/8" inverted flare	08		
		1/2" inverted flare	09		
		1/2" internal BSP	10		
		# 8 JIC fitting	11		
		1/4" NPT	14		



PILOTED DISCHARGE CHECK VALVES

N Series: These valves combine a pilot valve, discharge valve, and check valve into one unit. They are suitable for use with air compressors running at constant speed by either gas or electric power.

NSG models					
VALVE	INLET	OUTLET	VALVE	INLET	OUTLET
NSG-1	1/2" FNPT top	1/2" FNPT	NSG-9	3/8" FNPT top	1/2" FNPT
NSG-2	1/2" FNPT side	1/2" FNPT	NSG-10	3/8" FNPT side	1/2" FNPT
NSG-3	1/2" compression tube top	1/2" FNPT	NSG-11	3/8" compression tube top	1/2" FNPT
NSG-4	1/2" compression tube side	1/2" FNPT	NSG-12	3/8" compression tube side	1/2" FNPT
NSG-5	1/2" FNPT top	1/2" MNPT	NSG-13	3/8" FNPT top	1/2" MNPT
NSG-6	1/2" FNPT side	1/2" MNPT	NSG-14	3/8" FNPT side	1/2" MNPT
NSG-7	1/2" compression tube top	1/2" MNPT	NSG-15	3/8" compression tube top	1/2" MNPT
NSG-8	1/2" compression tube side	1/2" MNPT	NSG-16	3/8" compression tube side	1/2" MNPT
NG models					
NG-1	1/2" FNPT top	1/2" FNPT	NG-11	5/8" compression tube top	1/2" MNPT
NG-2	1/2" FNPT side	1/2" FNPT	NG-12	5/8" compression tube side	1/2" MNPT
NG-3	1/2" compression tube top	1/2" FNPT	NG-13	5/8" inverted flare top	1/2" FNPT
NG-4	1/2" compression tube side	1/2" FNPT	NG-14	5/8" inverted flare side	1/2" FNPT
NG-5	1/2" FNPT top	1/2" MNPT	NG-15	5/8" inverted flare top	1/2" MNPT
NG-6	1/2" FNPT side	1/2" MNPT	NG-16	5/8" inverted flare side	1/2" MNPT
NG-7	1/2" compression top	1/2" MNPT	NG-17	3/4" compression tube top	1/2" FNPT
NG-8	1/2" compression side	1/2" MNPT	NG-18	3/4" compression tube side	1/2" FNPT
NG-9	5/8" compression tube top	1/2" FNPT	NG-19	3/4" compression tube top	1/2" MNPT
NG-10	5/8" compression tube side	1/2" FNPT	NG-20	3/4" compression tube side	1/2" MNPT
Other available NSG & NG fittings:		Inlets	1/4" FNPT, 1/4" MNPT, 3/8" FNPT, 3/8" MNPT, 5/8" Compression		
		Outlets	3/8" FNPT, 3/8" MNPT, 1/4" FNPT		

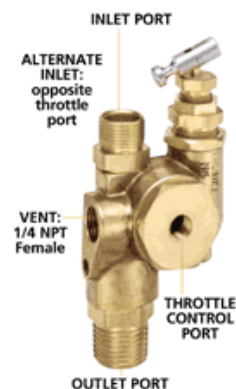

P2 is a 1/4" ported cap used for porting the alternate inlet not in use; P1 cap is 1/8" size



SA sealed adjustment is an epoxy seal put on the pilot adjustment to make it tamper resistant



Super Seal is available on male outlet fittings



The SU3 start unloader is used to ease compressor start-up in cold weather/lowered voltage applications



NS-Series muffler

PILOT VALVES

CDI p/n	Conrader p/n	Cut in (psi)	Cut out (psi)	Hex size	Height	Wt (oz)	List price (\$)	1-49	50-99	100+
P25F-B8	RCT-HU-125-150	125	150	3/4	3.88	6.4	28.00	15.12	13.16	12.04
P25F-B9	RCT-HU-100-125	100	125							
P25F-N	RCT-HU-145-175	145	175							
P25V-BB9	BG1-M-100-125	100	125		3.6	8	57.05	30.81	26.81	24.53
P25V-Y	BG1-M-140-170	140	170							

P25 series: Details of construction include a precision-machined, forged brass body, brass adjustment screws, and stainless steel ball and spring. Valve cut-in and cut-out pressures are factory set per customer specifications (if no specifications are given, valve is set at standard setting of 95-115 PSI). Valve is field adjustable and includes a mounting base, tapped with a 3/8-16UNC hole. Female ports are 1/4" NPT inlet and 1/8" NPT outlet. Options include a toggle for one-hand unloading, a lockout thumbscrew for dual control systems, and a 1/4" NPT nipple installed into the inlet port. Max. cut-out pressure: 250 psi, Min. cut-out pressure: 60 psi. Max. temp: 350°F. The **P25V** venting pilot valve gives you all of the features of the **P25** pilot valve plus a vent valve for unloading compressor discharge during compressor cut-out.



RCT series: Operating range is 20 - 250 psi. All RCT valves have 1/4" female NPT inlets (from tank) and 1/8" female NPT outlets (to other devices such as a throttle control or discharge valve), as well as a filtering element at the inlet. External pressure and differential adjustments allow for customization within a specific range based on the original factory setting. **BG1** models incorporate a hand unloader for manually unloading the compressor and are usually used on gas engine applications. They have a direct/unported vent and a felt muffler.

THROTTLE CONTROLS

CDI p/n	Conrader p/n	Length	HP	List price (\$)	1-49	50-99	100+
TC12-12	TCP-12-SST	12	2-7.5	23.85	12.88	11.21	10.26
TC12-18	TCP-18-SST	18		25.50	13.77	11.99	10.97
TC12-24	TCP-24-SST	24		26.65	14.39	12.53	11.46
TC12-30	TCP-30-SST	30		28.70	15.50	13.49	12.34
TC12-36	TCP-36-SST	36		29.50	15.93	13.87	12.69
TC12-48	TCP-48-SST	48					
TC12-12HD	TCLP-12-SST	12	8.5-11	36.75	19.85	17.27	15.80
TC12-18HD	TCLP-18-SST	18					
TC12-24HD	TCLP-24-SST	24					
TC12-30HD	TCLP-30-SST	30		38.50	20.79	18.10	16.56
TC12-36HD	TCLP-36-SST	36					
TC12-48HD	TCLP-48-SST	48		38.45	20.76	18.07	16.53



TC12 series: Throttle controls are used on gas engine-driven compressors to reduce engine speed to idle when a continuous run control (such as an **LGM series** vent unloader or a model **P25** pilot valve) has reached its "cut-out" setting. This saves fuel and reduces engine and compressor wear. The 1/8" NPT inlet of the **TC12** is connected to the throttle control port of the vent unloader or connected into a "tee" of the head unloader line of pilot valve installations. The cable end is attached to the throttle linkage on the engine, and the cable housing is anchored using the supplied cable clamps. Max. temp: 250°F. Min. pressure: 60 psi. Max. pressure: 250 psi.

TCP & TCLP series: Used in conjunction with a pilot device (**RC, B or N-series**), the **TCP & TCLP series** throttle controls control gas engine speed. While the compressor cycles, the throttle control slows down engine speed at unload pressure and speeds it back up at load pressure.

HINGED DUAL-DISC CHECK VALVES

Flexi-Hinge® check valves feature an improved design, high pressure ratings, and superior performance. Valves operate without a spring and will open with 0.10 psi of pressure and seal with 1/2 psi of back pressure.



Series 502M - MPT ends



Size	Length	Outer diameter	Width*	Weight (lbs)	Cv	List price (\$)	1-49	50-99	100+
1	3-1/2	1.315	1-3/4	0.6	37	213.00	115.02	100.11	91.59
1-1/4	3-1/2	1.66	2-1/16	0.9	65	218.00	117.72	102.46	93.74
1-1/2	4	1.90	2-3/8	1.2	91	230.00	124.20	108.10	98.90
2	4	2.375	2-13/16	2.0	160	274.00	147.96	128.78	117.82
2-1/2	5	2.875	3-5/16	2.8	410	318.00	171.72	149.46	136.74
3	5-1/2	3.50	4-1/8	4.5	620	374.00	201.96	175.78	160.82
4	6	4.50	5-1/8	6.9	965	480.00	259.20	225.60	206.40
5	7	5.562	6-3/16	11	1510	865.00	467.10	406.55	371.95
6	8	6.625	7-1/2	17	3025	1065.00	575.10	500.55	457.95

Series 513 - Victaulic ends



Size	Length	Outer diameter	Width*	Weight (lbs)	Cv	List price (\$)	1-49	50-99	100+
1	5-3/4	1.315	1-3/4	0.9	37	237.00	127.98	111.39	101.91
1-1/4	5-3/4	1.66	2-1/16	1.3	65	250.00	135.00	117.50	107.50
1-1/2	5-3/4	1.90	2-3/8	1.6	91	262.00	141.48	123.14	112.66
2	5-3/4	2.375	2-13/16	2.6	160	368.00	198.72	172.96	158.24
2-1/2	5-3/4	2.875	3-5/16	3.2	410	368.00	198.72	172.96	158.24
3	5-3/4	3.50	4-1/8	4.7	620	424.00	228.96	199.28	182.32
4	6-3/4	4.50	5-1/8	7.7	965	548.00	295.92	257.56	235.64
5	7-3/4	5.562	6-3/16	12.5	1510	1012.00	546.48	475.64	435.16
6	8-3/4	6.625	7-1/2	18.5	3025	1255.00	677.70	589.85	539.65

Series 514 - Plain ends



Size	Length	Outer diameter	Width*	Weight (lbs)	Cv	List price (\$)	1-49	50-99	100+
1	5-3/4	1.315	1-3/4	0.9	37	225.00	121.50	105.75	96.75
1-1/4	5-3/4	1.66	2-1/16	1.3	65	238.00	128.52	111.86	102.34
1-1/2	5-3/4	1.90	2-3/8	1.6	91	250.00	135.00	117.50	107.50
2	5-3/4	2.375	2-13/16	2.6	160	294.00	158.76	138.18	126.42
2-1/2	5-3/4	2.875	3-5/16	3.2	410	350.00	189.00	164.50	150.50
3	5-3/4	3.50	4-1/8	4.7	620	412.00	222.48	193.64	177.16
4	6-3/4	4.50	5-1/8	7.7	965	532.00	287.28	250.04	228.76
5	7-3/4	5.562	6-3/16	12.5	1510	972.00	524.88	456.84	417.96
6	8-3/4	6.625	7-1/2	18.5	3025	1217.00	657.18	571.99	523.31

* Over pivot shaft ends

Series 518 - Wafer style



Size	Length	Max Width	Disc protrusion #	Weight (lbs)	Cv	List price (\$)	1-49	50-99	100+
2"	1-3/8	4-1/4	1/2	4	160	470.00	253.80	220.90	202.10
3"	1-7/8	6	3/4	10	620	575.00	310.50	270.25	247.25
4"	2-3/8	7-1/2	7/8	12	965	745.00	402.30	350.15	320.35
5"	2-7/8	9	1-1/4	15	1510	1395.00	753.30	655.65	599.85
6"	3-3/8	10-1/2	1-1/2	25	3025	1783.00	962.82	838.01	766.69

At full flow, beyond downstream side of valve
Bolting conforms to ANSI B16.1 and B16.5

ACCESSORIES



PRESSURE CONTROL REGULATOR



CDI p/n	List price (\$)	1-49	50-99	100+
CR-25	23.05	12.45	10.83	9.91

The CR25 is an adjustable relief valve. Adjustments are made by dialing in the black plastic knob from 0 to 100 psi in 10 psi increments. Inlet is 1/4 NPT with Vibraseal thread sealant. Weight: 2.4 oz. Max. temp. 250°F. Max. inlet pressure: 200 psi.

FILLER VALVE



CDI p/n	List price (\$)	1-49	50-99	100+
TV-12	6.00	3.24	2.82	2.58

Use wherever a method of filling a tank with a standard air chuck is required. Brass valve core with Viton® and Teflon® seals, black plastic cap included.

Max. pressure: 250 psi. Max. temp: 250°F Male 1/8 NPT.

DRAIN COCK



Conrader p/n	CDI p/n	List price (\$)	1-49	50-99	100+
DCV14-4793	DU25-100	3.45	1.86	1.62	1.48

Designed for applications where a traditional drain cock is easily damaged. Opens easily and closes with minimum effort. Construction: brass body, knurled brass stem, nitrile O-ring ensures a bubble tight seal.

Vibra Seal® sealant standard. 1/4" NPT male. Max. pressure: 200 psi. Max. temp: 200°F.

DRAIN COCK WITH PULL CABLE



Conrader p/n	CDI p/n	Length	List price (\$)	1-49	50-99	100+
CDV14-24	DP25-1A-024	24	10.55	5.70	4.96	4.54
CDV14-60	DP25-1A-060	60	12.20	6.59	5.73	5.25

Brass stem tilts to open the valve at minimum pull. Stainless steel spring returns the stem to positively seal against the nitrile O-ring when cable is released. Construction: brass body, washer and stem. 1/4" NPT male. Vibra Seal® sealant standard. Max. pressure: 200 psi. Max. temp: 200°F.

LARGE INDUSTRIAL SAFETY VALVES



Kunkle 6000 Series

Side venting			
Model no.	Inlet size	Outlet size	Price*
6010DC	1/2	3/4	POR
6010DD	3/4	3/4	POR
6010ED	3/4	1	POR
6010EE	1	1	POR
6010FE	1	1-1/4	POR
6010FF	1-1/4	1-1/4	POR
6010GF	1-1/4	1-1/2	POR
6010GG	1-1/2	1-1/2	POR
6010HG	1-1/2	2	POR
6010HH	2	2	POR
6010JH	2	2-1/2	POR
6010JJ	2-1/2	2-1/2	POR
Top venting			
6182DC	1/2	N/A	POR
6182ED	3/4	N/A	POR
6182FE	1	N/A	POR
6182GF	1-1/4	N/A	POR
6182HG	1-1/2	N/A	POR
6182JH	2	N/A	POR

- Full nozzle design with bronze/brass trim
 - Optional Viton seats available for exceptional leak-free performance, reduced maintenance costs, and multiple cycles with tight shutoff
 - Operating pressure range: 3 to 300 psi
 - Operating temp. range: -60°F - 406°F (51° to 208° C)
 - Available in stock pressure settings of 125, 135, 140, 150, 165, 175, and 200 psi
 - Other pressures and settings available upon request
- *POR = Price on request, please call for quote.



See page 50 for flow chart and orifice sizes.

BALL VALVES, GATE VALVES, SWING CHECKS, Y-STRAINERS



FULL PORT BRASS BALL VALVES, UL & CSA APPROVED

600 psi CWP, 150 psi WSP service, suitable for vacuum service to 29.9" Hg. Temp. range: -40°F to 365°F.

Part no.	F X F NPT	List price (\$)	1-49	50+
KTC-25	1/4	12.01	6.49	5.64
KTC-33	3/8	12.02	6.49	5.65
KTC-50	1/2	20.01	10.81	9.41
KTC-75	3/4	25.89	13.98	12.17
KTC-100	1	48.93	26.42	23.00
KTC-125	1-1/4	74.46	40.21	35.00
KTC-150	1-1/2	106.77	57.66	50.18
KTC-200	2	172.66	93.24	81.15

Part no.	M X F	List price (\$)	1-49	50+
KTCM-25	1/4	12.41	6.70	5.83
KTCM-33	3/8			
KTCM-50	1/2	17.98	6.70	5.83
KTCM-75	3/4	26.79	14.47	12.59
KTCM-100	1	47.13	25.45	22.15
KTCM-125	1-1/4	67.79	36.61	31.86
KTCM-150	1-1/2	98.28	53.07	46.19
KTCM-200	2	172.17	92.97	80.92

FULL PORT BRASS BALL VALVES

600 psi CWP, 150 psi WSP service, suitable for vacuum service to 29.9" Hg., Temp. range: 0°F to 365°F. MBB-50 available with "T" handle (MBB-50TH).

Part no.	F X F NPT	List price (\$)	1-49	50+
FBB-25	1/4	10.36	5.59	4.87
FBB-33	3/8			
FBB-50	1/2	14.77	7.98	6.94
FBB-75	3/4	21.88	11.82	10.28
FBB-100	1	34.88	18.84	16.39
FBB-125	1-1/4	58.85	31.78	27.66
FBB-150	1-1/2	83.28	44.97	39.14
FBB-200	2	119.52	64.54	56.17
FBB-250	2-1/2	282.63	152.62	132.84
FBB-300	3	439.95	237.57	206.78
FBB-400	4	750.89	405.48	352.92

Part no.	M X F NPT	List price (\$)	1-49	50+
MBB-25	1/4	10.90	5.89	5.12
MBB-33	3/8			
MBB-50	1/2	15.72	8.49	7.39
MBB-75	3/4	26.09	14.09	12.26
MBB-100	1	35.96	19.42	16.90



CWP = COLD WORKING PRESSURE

WSP = WORKING STEAM PRESSURE

NICKEL PLATED FULL PORT BRASS BALL VALVES

600 psi CWP, 150 psi WSP service, suitable for vacuum service to 29.9" Hg., Temp range: 0°F to 365°F

Part no.	F X F	List price	1-49	50+
FPC-25	1/4	11.24	6.07	5.28
FPC-38	3/8			
FPC-50	1/2	17.56	9.48	8.25
FPC-75	3/4	25.22	13.62	11.85
FPC-100	1	37.16	20.07	17.47
FPC-125	1-1/4	62.82	33.92	29.53
FPC-150	1-1/2	87.35	47.17	41.05
FPC-200	2	125.77	67.92	59.11
FPC-250	2-1/2	335.27	181.05	157.58
FPC-300	3	471.18	254.44	221.45
FPC-400*	4	788.51	425.80	370.60

Part no.	M X F NPT	List price (\$)	1-49	50+
MPC-25	1/4	11.77	6.36	5.53
MPC-33	3/8			
MPC-50	1/2	19.17	10.35	9.01
MPC-75	3/4	27.80	15.01	13.07
MPC-100	1	38.27	20.67	17.99



NICKEL PLATED FULL PORT BRASS LOCKING BALL VALVES

600 psi CWP, 150 psi WSP service, suitable for vacuum service to 29.9" Hg., Temp range: 0°F to 365°F. For use with 9/32" dia lock shackle; not supplied.

Part no.	F X F NPT	List price (\$)	1-49	50+
LBV-25	1/4	13.55	7.32	6.37
LBV-38	3/8			
LBV-50	1/2	19.53	10.55	9.18
LBV-75	3/4	28.37	15.32	13.33
LBV-100	1	37.75	20.39	17.74
LBV-120	1-1/4	65.19	35.20	30.64
LBV-150	1-1/2	90.01	48.61	42.30
LBV-200	2	129.22	69.78	60.73
LBV-250	2-1/2	340.72	183.99	160.14
LBV-300	3	490.71	264.98	230.63
LBV-400	4	863.92	466.52	406.04

Part no.	M X F NPT	List price (\$)	1-49	50+
MLBV-25	1/4	13.21	7.13	6.21
MLBV-33	3/8			
MLBV-50	1/2	20.04	10.82	9.42
MLBV-75	3/4	30.17	16.29	14.18
MLBV-100	1	39.27	21.21	18.46



AUTO DRAIN SAFETY EXHAUST BALL VALVES

Part no.	F X F NPT	List price (\$)	1-49	50+
ADV-25	1/4	14.68	7.93	6.90
ADV-33	3/8			
ADV-50	1/2	20.65	11.15	9.71
ADV-75	3/4	28.62	15.45	13.45
ADV-100	1	46.64	25.19	21.92
ADV-120	1-1/4	81.53	44.03	38.32
ADV-150	1-1/2	118.57	64.03	55.73
ADV-200	2	190.30	102.76	89.44



STAINLESS STEEL BALL VALVES

Part no.	F X F NPT	List price (\$)	1-49	50+
SSV-25	1/4	57.53	31.07	27.04
SSV-33	3/8			
SSV-50	1/2	64.45	34.80	30.29
SSV-75	3/4	81.66	44.10	38.38
SSV-100	1	113.73	61.41	53.45
SSV-120	1-1/4	190.29	102.76	89.44
SSV-150	1-1/2	280.21	151.31	131.70
SSV-200	2	414.45	223.80	194.79

2000 psi (CWP) 150 psi (WSP) 1/4"- 1" service; 1500 psi (CWP) 150 psi (WSP) service 1-1/4" - 2", temp. range: -60°F - 450°F 2-piece 316 stainless steel construction. Lockable steel handle w/vinyl grip, use with 9/32" dia lock shackle (not supplied).



MINI NICKEL PLATED BRASS BALL VALVES

450 psi (CWP) 150 psi (WSP) service. Temp. range: -20°F to 370°F.

Part no.	F X F NPT	List price (\$)	1-49	50+
CBV-12	1/8	13.38	7.23	6.29
CBV-25	1/4			
CBV-33	3/8	16.17	8.73	7.60
CBV-50	1/2			



F X F WITH WEDGE HANDLE

Part no.	M X F NPT	List price (\$)	1-49	50+
CMV-12	1/8	13.38	7.23	6.29
CMV-25	1/4			
CMV-33	3/8	16.17	8.73	7.60
CMV-50	1/2			



M X F WITH WEDGE HANDLE

Part no.	M X F NPT	List price (\$)	1-49	50+
CMVL-25	1/4	12.00	6.48	5.64
CMVL-33	3/8			



M X F WITH LEVER

Part no.	F X F NPT	List price (\$)	1-49	50+
CBV-50TH	1/2	16.55	8.94	7.78



F X F WITH T-HANDLE

CWP = COLD WORKING PRESSURE

WSP = WORKING STEAM PRESSURE

Y-STRAINERS

600 psi (CWP) 150 psi (WSP) service, temp. range: -20°F - 425°F, heavy duty forged brass construction, easy clean plug, screw caps are straight threaded with PTFE gaskets, 304 stainless steel 50 mesh screen for 1/4" - 1" sizes; 20 mesh screen on 1-1/4" - 2" sizes.



Part no.	F X F NPT	List price (\$)	1-49	50+
YSFB-25	1/4	24.81	13.40	11.66
YSFB-38	3/8	24.81	13.40	11.66
YSFB-50	1/2	27.32	14.75	12.84
YSFB-75	3/4	41.81	22.58	19.65
YSFB-100	1	65.23	35.22	30.66
YSFB-125	1-1/4	98.12	52.98	46.12
YSFB-150	1-1/2	174.50	94.23	82.02
YSFB-200	2	270.39	146.01	127.08

GATE VALVES

200 psi (CWP) 125 psi (WSP) service, temp. range: -40°F - 300°F, forged brass construction, body & bonnet are connected with a tight metal to metal leak proof seat, screwed bonnet, non-rising stem, solid wedge disc & integral seats, black round metal handle.



Part no.	F X F NPT	List price (\$)	1-49	50+
BGV-75	3/4	26.24	14.17	12.33
BGV-100	1	35.93	19.40	16.89
BGV-120	1-1/4	52.37	28.28	24.61
BGV-150	1-1/2	66.73	36.03	31.36
BGV-200	2	109.06	58.89	51.26
BGV-250	2-1/2	214.43	115.79	100.78
BGV-300	3	317.75	171.59	149.34
BGV-400	4	495.65	267.65	232.96

SWING CHECK VALVES

300 psi (CWP) 150 psi (WSP) service, max. operating temp: 200°F., heavy duty bronze construction, recommended for preventing back flow in commercial and industrial applications.



Part no.	F X F NPT	List price (\$)	1-49	50+
SCY-50	1/2	48.50	26.19	22.80
SCY-75	3/4	60.49	32.66	28.43
SCY-100	1	85.69	45.27	40.27
SCY-120	1-1/4	122.37	66.08	57.51
SCY-150	1-1/2	162.79	87.91	76.51
SCY-200	2	248.81	134.36	116.94

BALL VALVE STRAINER COMBINATION

600 psi (CWP) 150 psi (WSP) service, temp. range: -4°F - 200°F, solid brass body with stainless steel 50 mesh screen, ideal for connection to an automatic timer drain or can be used alone as a tank drain, unique design allows valve to be closed and screen to be cleaned without loss of air pressure in tank or drain, 1/2 MPT valve inlet is also threaded 1/4 FPT internally for versatility, zinc die cast handle.

Part no.	Chrome plated	M X F NPT	List price (\$)	1-49	50+
S402	Yes	1/2in - 1/4out	19.20	10.37	9.02
S302	No		19.20	10.37	9.02
S404	Yes	1/2in - 1/2out	19.20	10.37	9.02
S304	No		19.20	10.37	9.02



AIR INTAKE FILTERS & ELEMENTS

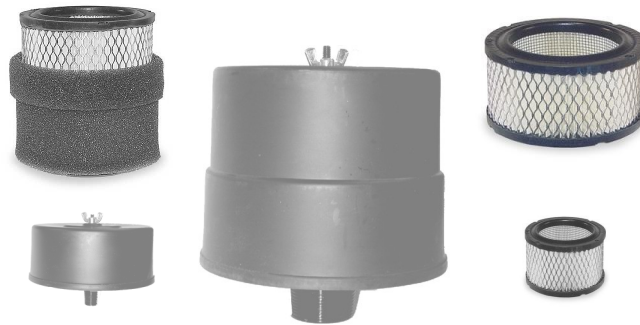

FILTER HOUSINGS WITH CLOTH ELEMENTS AND SILENCING TUBES

P&A part no.	NPT	Height	SOLBERG part no.	List price (\$)	1-49	50-99	100+
S16C-050	1/2	5	FS-15-050	35.87	19.37	16.86	15.42
S16C-075	3/4		FS-15-075	38.05	20.55	17.88	16.36
S16C-100	1		FS15-100	41.54	22.43	19.52	17.86
S20CP-100	1	7	FS-19P-100	58.91	31.81	27.69	25.33
S20CP-125	1-1/4		FS-19P-125	61.12	33.00	28.73	26.28
*S20CP-125-10T	1-1/4		FS-19P-125-9T	62.43	33.71	29.34	26.84
S20CP-150	1-1/2		FS-19P-150	61.82	33.38	29.06	26.58
*S20CP-150-10T	1-1/2		FS-19P-150-9T	73.7	39.80	34.64	31.69
*S20CP-200-10T	2		FS-19P-200-10T	76.21	41.15	35.82	32.77
*S20CP-250-10T	2-1/2		FS-19P-250-9T	78.94	42.63	37.10	33.94



S16



S20

All housings are 6-3/4 outside diameter

* Internal 10-tube construction

REPLACEMENT ELEMENTS

	P&A part no.	ID	OD	Height	SOLBERG part no.	List price (\$)	1-49	50-99	100+
Cloth (polyester)	10C	1-1/8	2-1/4	2-1/4	N/A	5.60	3.02	2.63	2.41
	16C	3	4-3/8	2-5/16	15	9.44	5.10	4.44	4.06
	20CP	3	4-3/8	4-3/4	19P	21.15	11.42	9.94	9.09
	32CP	3-5/8	5-3/4	4-3/4	31P	41.38	22.35	19.45	17.79
Paper	10D	1-1/8	2-1/4	2-1/4	N/A	5.73	3.09	2.69	2.46
	16D	3	4-3/8	2-5/16	14	6.69	3.61	3.14	2.88
	20DP	3-5/8	5-3/4	4-3/4	18P	13.02	7.03	6.12	5.60
	32DP	3-5/8	4-3/8	4-3/4	30P	26.40	14.26	12.41	11.35



10D or 10C



16D or 16C



20D or 20C



32D or 32C

FILTER HOUSINGS WITH PAPER ELEMENTS AND SILENCING TUBES



16D



20D

P&A part no.	NPT	Height	SOLBERG part no.	List price (\$)	1-49	50-99	100+
S16D-050	1/2	5	FS-14-050	43.55	23.52	20.47	18.73
S16D-075	3/4		FS-14-075	44.22	23.88	20.78	19.01
S16D-100	1		FS14-100	44.58	24.07	20.95	19.17
S20DP-100	1	7	FS-18P-100	55.17	29.79	25.93	23.72
S20DP-125	1-1/4		FS-18P-125	56.93	30.74	26.76	24.48
* S20DP-125-10T	1-1/4		FS-18P-125-9T	58.74	31.72	27.61	25.26
S20DP-150	1-1/2		FS-18P-150	57.61	31.11	27.08	24.77
* S20DP-150-10T	1-1/2		FS-18P-150-9T	65.50	35.37	30.79	28.17
* S20DP-250-10T	2-1/2		FS-1BP-250-9T	82.80	44.71	38.92	35.60

All housings are 6-3/4 outside diameter

* 10-tube construction



F10C



F10D

MINI FILTER HOUSINGS

	P&A part no.	NPT	SOLBERG part no.	List price (\$)	1-49	50-99	100+
cloth element	F10C-025	1/4	F09-025	32.98	17.81	15.50	14.18
	F10C-038	3/8	F09-038	33.73	18.21	15.85	14.50
	F10C-050	1/2	F09-050	34.08	18.40	16.02	14.65
paper element	F10D-025	1/4	F08-025	33.45	18.06	15.72	14.38
	F10D-038	3/8	F08-038	34.18	18.46	16.06	14.70
	F10D-050	1/2	F08-050	34.62	18.69	16.27	14.89

Housings are 4 high X 3 diameter



S32CP



S32DP

EXTRA-LARGE FILTER HOUSINGS WITH SILENCING TUBES

	P&A part no.	NPT	SOLBERG part no.	List price (\$)	1-49	50-99	100+
cloth element	S32CP-150	1-1/2	N/A	145.09	78.35	68.19	62.39
	S32CP-200	2	FS-31P-200	146.11	78.90	68.67	62.83
	S32CP-250	2-1/2	FS-31P-250	147.42	79.61	69.29	63.39
	S32CP-300	3	N/A	152.32	82.25	71.59	65.50
paper element	S32DP-150	1-1/2	N/A	120.50	65.07	56.64	51.82
	S32DP-200	2	FS-30P-200	121.02	65.35	56.88	52.04
	S32DP-250	2-1/2	FS-30P-250	121.76	65.75	57.23	52.36
	S32DP-300	3	N/A	122.40	66.10	57.53	52.63

Housings are 8-1/2 high X 9-1/2 diameter

ARROW FRL QUICK REFERENCE

All dimensions & pipe sizes are in inches

Please contact Pennington & Associates for a complete Arrow product line catalog



PARTICULATE FILTERS

Part no.	FPT	Bowl capacity (oz)	Max flow rate	List price (\$)
F300-01	1/8	1	27	32.40
F300-02	1/4			
F352	1/4	5	48	66.40
F353	3/8		75	
F354	1/2		100	
F374W	1/2	10	160	107.10
F376W	3/4		230	
F378W	1		245	
F329-06W	3/4	29	260	195.60
F329-08W	1		300	
F329-10W	1-1/4		400	361.10
F329-12W	1-1/2		425	
F358HF-12	1-1/2	50	550	575.40
F3N1-12	1-1/2	100	910	797.60
F3N1-16	2			965.60
F3N1-16T				
F3NHF-24	3	200	1,300	981.70
F3NHF-24T				1149.60

COALESCING FILTERS

Part no.	FPT	Bowl capacity (oz)	Max flow rate (scfm)	List price (\$)
F500-01	1/8	1	15	73.20
F500-02	1/4			
F552W	1/4	6	24	142.60
F553W	3/8	6	37	142.60
F554W	1/2			
F574W	1/2	10	55	198.40
F576W	3/4		60	
F578W	1		65	
F584W	1/2	20	90	259.80
F586W	3/4		110	
F588W	1		135	
F505-06W	3/4	29	150	343.50
F505-08W	1			
F508-08W	1	60	200	500.70
F508-10W	1-1/4			777.50
F508-12W	1-1/2		310	777.50
F510-08	1	100	310	1030.80
F510-10	1-1/4			
F510-12	1-1/2			
F510-16	2	200	415	1147.70
F518-12	1-1/2			1556.40
F518-16	2			1731.70
F528-16	2	300	765	2140.80
F511-24	3	100	620	1778.50
F519-24	3	200	770	2356.00
F529-24	3	300	1100	2608.30

FILTER OPTION	PRICE ADJUSTMENT
D DIFFERENTIAL PRESSURE GAUGE	109.60
F INTERNAL FLOAT DRAIN	39.10
J OVERNITE DRAIN (PLASTIC BOWLS)	5.00
K OVERNITE DRAIN (METAL BOWLS)	11.20
M METAL BOWL (EPOXY COATED)	F300: 5.60 F350: 7.40 F370: - 7.90 F329: - 15.00 F358HF, F3N1, F3NHF: included
T EXTERNAL FLOAT DRAIN	164.70 (F3N1 only)
W METAL BOWL w/SIGHT GLASS	F300: N/A F350: 13.10 F370, F329: included F358: 15.80 F3N: 26.80
Z PISTON DRAIN (MINI FILTERS ONLY)	F300 series: 22.00 F350 series: 29.40
5 5 MICRON ELEMENT	F358, F3N: N/A All others: no charge
3 3 MICRON ELEMENT	F300: N/A F350, F370: 5.00 F329: 19.00 F358, F3N: 20.30

Add suffix to part no., first letter and then number codes, ex. F352W3 is a filter with metal bowl, sight glass, and 3 micron element.

Bowl type	Max pressure or range (psi)	Operating temp. range (°F)
PLASTIC	150	40 - 120
METAL	250	40 - 200
W/ SIGHT GLASS	250	40 - 160
W/ AUTO DRAIN	30-175	40 - 120

WARNING! POLYCARBONATE PLASTIC BOWLS COULD RUPTURE IF EXPOSED TO INCOMPATIBLE CHEMICALS WHETHER INSIDE OR OUTSIDE THE BOWL. IF SUCH CHEMICALS ARE PRESENT USE A METAL BOWL.

REGULATORS

MINIATURE			
Model no.	FPT	Body material	List price (\$)
R161	1/8	zinc	28.00
R162	1/4	zinc	
R261	1/8	nylon	27.10
R262	1/4	nylon	
Max. supply pressure: 250 psig, operating temp. range: 40°- 120°F, max. flow rate: 25 scfm			



MINIATURE		
Model no.	FPT	List price (\$)
B741	1/8	57.30
B742	1/4	
Max. supply pressure: 150 psig, standard pressure adjustment range: 5 - 125 psi, max. flow rate: 20 scfm, max. initial pressure: 150 psi		



STANDARD			
Model no.	FPT	Max. flow rate (scfm)	List price (\$)
R352	1/4	50	61.50
R353	3/8	80	
R354	1/2	100	
Max. supply pressure: 250 psig, operating temp. range: 40°- 120°F			



STANDARD			
Model no.	FPT	Max. flow rate (scfm)	List price (\$)
B752	1/4	50	120.20
B753	3/8	80	
B754	1/2	100	
Max. supply pressure: 250 psig, operating temp. range: 40°- 120°F			



MID FLOW			
Model no.	FPT	Max. flow rate (scfm)	List price (\$)
R374	1/2	215	89.50
R376	3/4	220	
R378	1	250	
Max. supply pressure: 250 psig, operating temp. range: 40° - 120°F			



HIGH FLOW			
Model no.	FPT	Max. flow rate (scfm)	List price (\$)
R398	1	600	183.90
R3910	1-1/4	700	203.80
R3912	1-1/2	800	
Max. supply pressure: 250 psig, operating temp. range: 40°- 120°F			



REGULATOR & INTEGRAL FILTER/REGULATOR OPTIONS					
DESCRIPTION			DESCRIPTION		
List price (\$)			List price (\$)		
B	2-POSITION MECHANICAL LOCK KNOB	6.60	U	NO GAUGE PORTS	N/C
F	INTERNAL FLOAT DRAIN	39.10	V	ALL 1/4 PORTS (4) (R262)	N/C
G	GAUGE	15.50	W	METAL BOWL w/SIGHT GLASS	13.20
H	HIGH PRESSURE (10-250 PSI)	11.30 (R39) 5.60 (R35, R37)	Y1	VITON DIAPHRAGM AND INNER VALVE SEAT (R261 & R262 ONLY)	14.70
I	INSTRUMENT PRESSURE (3-20 PSI)	N/C	Y2	EPDM DIAPHRAGM AND INNER VALVE SEAT (R261 & R262 ONLY)	14.70
J	OVERNIGHT DRAIN PLASTIC BOWL	5.00	Z	PKF300 PISTON DRAIN FOR MINI w/METAL BOWL	22.00
K	OVERNIGHT DRAIN METAL BOWL	11.20	Z	PISTON DRAIN PK35 STANDARD POLY DRAIN ONLY	29.40
L	LOW PRESSURE (3-60 PSI)	N/C	5	5 MICRON ABSOLUTE ELEMENT	N/C
M	METAL BOWL	5.60 (B74) 7.40 (B75)	3	3 MICRON ABSOLUTE ELEMENT	5.00
N	NON- RELIEVING	N/C	ADD SUFFIX TO PART NO. IN ALPHANUMERIC ORDER		
P	PANEL MOUNT T-HANDLE ADJUST	2.10 (B74) 6.20 (B75)			
T	T-HANDLE ADJUST	N/C			

MINIATURE RELIEF VALVES			
Model no.	FPT	Material	List price (\$)
E191	1/8	Die cast	32.40
E192	1/4	metal	



MINIATURE RELIEF VALVES			
Model no.	FPT	Material	List price (\$)
E291	1/8	Plastic	34.30
E292	1/4		

Please contact Pennington & Associates for a complete Arrow product line catalog

LUBRICATORS

MINIATURE FOG:

Designed for low flow applications where space is limited.

MINIATURE					
Model no.	FPT	Bowl material	Bowl capacity	Max. flow rate (scfm)	List price (\$)
L181	1/8	plastic	1 oz	16	42.00
L182	1/4				

ARROWFOG:

Sends all metered oil down line in fog droplets; accommodates a wide range of applications.

STANDARD ARROWFOG					
Model no.	FPT	Bowl material	Bowl capacity	Max. flow rate (scfm)	List price (\$)
L352	1/4	plastic	5 oz	16	83.90
L353	3/8			82	
L354	1/2			142	

ULTRAFOG:

Allows precise adjustment; atomizes oil droplets to a fine mist for reclassification in the bowl before sending lighter particles of oil down line.

STANDARD ULTRAFOG					
Model no.	FPT	Bowl material	Bowl capacity	Max. flow rate (scfm)	List price (\$)
L452	1/4	plastic	5 oz	16	83.90
L453	3/8			82	
L454	1/2			142	

MIDFLOW ARROWFOG

Model no.	FPT	Bowl	Bowl	Max. flow	List price
L374W	1/2	metal w/sight	10 oz	142	115.00
L376W	3/4				

MIDFLOW ULTRAFOG

Model no.	FPT	Bowl material	Bowl capacity	Max. flow rate (scfm)	List price (\$)
L474W	1/2	metal w/sight	10 oz	142	115.00
L476W	3/4				

ARROWICK:

Uses an adjustable saturated wick to send smallest possible droplets of oil down line. Eliminates problems encountered with dome style lubricators.

HIGHFLOW ARROWICK					
Model no.	FPT	Bowl material	Bowl capacity	Max. flow rate (scfm)	List price (\$)
4106	3/4	metal	29 oz	175	165.10
4108	1				306.00
4112	1-1/2				

LUBRICATOR OPTIONS

		L1 series List price (\$)	L35 series List price (\$)	L37 series List price (\$)	L38 series List price (\$)	L45 series List price (\$)	L47 series List price (\$)	L48 series List price (\$)	41 series List price (\$)	41 LCM series List price (\$)
M	metal bowl	5.80	7.60	- 8.30	- 10.60	7.60	- 8.30	- 10.60	STD	N/A
W	metal bowl w/sight	N/A	12.90	STD	STD	13.20	STD	STD	15.30	STD



FRL COMBINATIONS

Please contact Pennington & Associates
for a complete Arrow product line catalog



MINIATURE		
Model no.	FPT	List price (\$)
7681	1/8	123.60
7682	1/4	



STANDARD C - w/ modular end port inserts		
Model no.	FPT	List price (\$)
C33352	1/4	290.10
C33353	3/8	
C33354	1/2	293.40
C33356	3/4	



N - nipple connected		
Model no.	FPT	List price (\$)
N33352	1/4	243.60
N33353	3/8	
N33354	1/2	249.30



IN-LINE DESICCANT DRYERS				
Model no.	FPT	Capacity	SCFM	List price (\$)
D12-04	1/2	1 qt	5-15	279.40
D12-04XL		2 qt	15-25	323.20
D12-04XXL	3/4	1 gal	40	336.90
D12-06			50	



STAGEAIR DESICCANT DRYING SYSTEM				
Model no.	Description	Capacity	SCFM	List price (\$)
VC7510	1/2" StageAir System	1 qt	5-15	643.00
VC7510XL	1/2" StageAir - Large Capacity	2 qt	15-25	734.60
VC7525	1/2" StageAir - 3/4 outlet	1 gal	25-50	1468.60
C7612XXL	1/2" StageAir - 1/2 outlet	1 gal	40	699.70
D7612	1/2" Economy desiccant dryer	1 qt	15	322.60

See p. 48 for SORBEAD® blue silica gel dessicant



3-way OSHA lockout slide valve - nipple connected		
Model no.	FPT	List price (\$)
V202	1/4	32.50
V203	3/8	
V204	1/2	



Miniature in-line desiccant dryer 1/4 MPT & 1/4 FPT connections, bi-directional flow				
Model no.	Capacity (scfm)	Max. temp (°F)	Max. pressure (psi)	List price (\$)
DFD-10 (2 pack)	15	130	125	32.20



ARROW SINTERED PRODUCTS

MUFFLERS / VENTS



All dimensions & pipe sizes are in inches
Please contact Pennington & Associates
for a complete Arrow product line catalog

Part no.		Thread	Overall length	Diameter	Weight (lbs)	List price (\$)	
NPT	BSP					NPT	BSP
ASP-M*	N/A	10/32	45/64	5/16	.01	2.01	N/A
ASP-1	ASP-1BS	1/8	1-1/8	7/16	.02	2.25	2.51
ASP-2	ASP-2BS	1/4	1-3/8	9/16	.04	2.51	2.76
ASP-3	ASP-3BS	3/8	1-1/2	11/16	.06	3.45	3.78
ASP-4	ASP-4BS	1/2	1-7/8	7/8	.10	4.85	5.22
ASP-6	#	3/4	2-1/4	1-1/16	.18	7.79	NA
ASP-8	#	1	2-7/8	1-5/16	.34	11.17	NA
ASP-10	#	1-1/4	3-1/4	1-11/16	.62	18.09	NA
ASP-12	#	1-1/2	3-11/16	2	.88	24.17	NA
ASP-420**	#	1/2-20	1-3/16	5/8	DISCONTINUED		

Quiet Flow mufflers/filters utilize porous sintered bronze directly bonded to nickel plated steel pipe thread fittings to diffuse air and muffle noise from the exhausted ports of valves, cylinders, and air tools. These units offer a combination of small size with the greatest possible sound deadening qualities to reduce exhaust noise to acceptable levels within OSHA noise requirements. In addition, these units are used as filters for gasoline, oil, and air. Standard units contain a 40 micron element; 20 and 90 micron units are also available on special order. Model ASP-420 is a female threaded (1/2" - 20) muffler for use on exhaust ports of most solenoid valves, and can be used with "exhaust to atmosphere" valves, including Skinner, Peter Paul, Allied, KIP, Pre Dyne or any valve using 1/2" - 20 threads on the sleeve.

Specifications	
Max. operating pressure (psi)	300
Operating temp. range (°F)	35 - 300

* Furnished with gasket
** Female threads fit most solenoid valve exhaust ports
Special order; contact us for availability



Part no.		Thread	Overall length	Diameter	Weight (lbs)	List price (\$)	
NPT	BSP					NPT	BSP
ASP-1BV	ASP-1BVBS	1/8	7/16	7/16	.01	1.38	1.51
ASP-2BV	ASP-2BVBS	1/4	5/8	9/16	.02	1.62	1.76
ASP-3BV	ASP-3BVBS	3/8	3/4	11/16	.04	2.20	2.41
ASP-4BV	ASP-4BVBS	1/2	7/8	7/8	.06	2.83	3.07
ASP-6BV		3/4	1	1-1/16	.10	5.09	N/A
ASP-8BV		1	1-5/16	1-5/16	.23	7.21	N/A
ASP-10BV		1-1/4	1-13/32	1-11/16	.41	13.57	N/A
ASP-12BV		1-1/2	1-1/2	2	.56	14.62	N/A

Specifications	
Max. operating pressure (psi)	150
Operating temp. range (°F)	35 - 300

Breather vents have many applications, including vacuum relief or pressure equalization on gear boxes, oil tanks or reservoirs, common uses can be found on single acting cylinders or valves to prevent dirt and foreign particles from entering ports open to the atmosphere, units have a nickel plated steel insert, all have standard pipe thread fittings for quick assembly and removal for cleaning, the filter element within the standard breather vent is rated for 40 micron filtration and can also be obtained for 20 or 90 micron filtration on special order.



Part no.	Thread NPT	Max adj. flow (scfm)	Approximate height at full flow	Hex size	Weight (lbs)	List price (\$)
ASP-1SC	1/8	20	1-5/16	1/2	.07	5.31
ASP-2SC	1/4	30	1-9/16	9/16	.09	5.89
ASP-3SC	3/8	40	1-5/8	11/16	.14	7.55
ASP-4SC	1/2	60	2	7/8	.25	9.89
ASP-6SC	3/4	70	2-3/8	1 1/16	.42	19.20
ASP-8SC	1	100	2-1/2	1 5/16	.56	26.13
ASP-1SCH	1/8	30	1-9/16	9/16	.09	5.89
ASP-2SCH	1/4	40	1-5/8	11/16	.14	7.55
ASP-3SCH	3/8	60	2	7/8	.25	9.34
ASP-4SCH	1/2	70	2-3/8	1 1/16	.42	15.95

Specifications	
Max. operating pressure (psi)	300
Operating temp. range (°F)	35 - 300

Quiet Flow speed control mufflers provide an infinite variation of metering air flow at an acceptable sound level on exhaust ports of air valves with complete safety. With linear adjusting ability, the speed of an operating cylinder or air tool may be increased or decreased with the adjusting screw. The final position is then locked in place by the lock nut. Objectionable exhaust air noise is eliminated by the surrounding sintered bronze sleeve. Complete safety in operation is featured in Quiet Flow speed control mufflers. The sintered bronze sleeve is held securely in position and protected by an integral shroud. A 40 micron element is standard. High flow units offer more surface area for increased flow.



MUFFLERS / FILTERS

Please contact Pennington & Associates for a complete Arrow product line catalog

Part no.	Male NPT	Overall length	Diameter	Weight (lb)	List price (\$)
SQF-1	1/8	2-7/64	13/16	.02	5.10
SQF-2	1/4	2-15/64		.03	
SQF-3	3/8	3-27/64	1-1/4	.09	7.47
SQF-4	1/2	3-35/64			



Specifications	
Max. operating pressure (psi)	150
Operating temp. range (°F)	35 - 120

Economy silencer mufflers incorporate a 50 mesh, self-cleaning, stainless steel screen in a strong, protective glass-filled nylon housing which is ultrasonically welded for maximum strength. This unit offers greater flow with less pressure drop than the ASP Series, while reducing noise levels. See sales literature for performance charts, flow information, and sound characteristics.

Heavy-duty metal silencer mufflers are a quick and inexpensive way to help reduce work area noise. At the same time, they protect the inside of pneumatic valves from contamination which can enter through the exhaust ports. Units 1/8" through 1" feature a 50 mesh, self-cleaning stainless steel screen, corrosion-resistant aluminum shell, high flow and minimal back pressure. Download sales literature for performance charts, flow information, and sound characteristics.

Part no. - female	Part no. - male	NPT	Overall length	Hex size	Weight (lbs)	List price female (\$)	List price male (\$)
ASQF-1F	ASQF-1M	1/8	1-7/8	5/8	.05	7.54	7.54
ASQF-2F	ASQF-2M	1/4			.06		
ASQF-3F	ASQF-3M	3/8	3-1/4	1	.23F/.21M	11.36	11.36
ASQF-4F	ASQF-4M	1/2			.38F/.23M		
ASQF-6F	ASQF-6M	3/4	4-5/8	1-5/8	.56	24.14	24.14
ASQF-8F	ASQF-8M	1			.58		
ASQF-10F	N/A	1-1/4	5-1/2	2-1/2	.75	78.23	N/A
ASQF-12F		1-1/2			.81	79.75	
ASQF-16F		2	6-7/16	3	1.62	124.47	



Specifications	
Max. operating pressure (psi)	300
Operating temp. range (°F)	35 - 160

Part no.	NPT	Overall length	Diameter	Weight (lb)	List price (\$)	Element & seal kit part no.	List price (\$)	Spring kit part no.	List price (\$)
9071	1/8	2-5/16	3/4	.08	8.09	EK9072	2.37	SK9072	1.74
9072	1/4				12.81				
9073	3/8								
9074	1/2	3-1/4	1-1/2	.46	28.89	EK9074	5.98	SK9074	
9074M	1/2	3-13/16			30.50				
9076	3/4	3-1/4			28.89				
9076M	3/4	3-13/16			30.50				



Specifications	
Max. oper. pressure (psi)	500
Operating temp.(°F)	35 - 200, w/ Viton O-ring: 35 - 400

In-line tool filters are designed specifically for the protection of small air tools, such as impact wrenches, nut runners, grinders and screwdrivers. They reduce downtime, prevent costly tool repairs, and extend tool life. The all-anodized, lightweight aluminum housing is compact and can be used directly before the air tool. Elements can be replaced quickly at nominal cost. The standard element is 40 micron, which insures minimum pressure drop. Elements can be obtained in 20 or 90 micron filtration on special order. These filters can also be used in low pressure hydraulic applications, in which case we recommend using a 20 micron element. Special Viton O-rings are available for oil systems where chemical compatibility may be a problem.

Part no.	NPT	Overall length	Diameter	Weight (lb)	List price (\$)	Element & seal kit part no.	List price (\$)	Spring kit part no.	List price (\$)
9052	1/4	3-1/4	1-1/2	.46	28.89	EK9052	7.21	SK9052	2.76
9053	3/8	3-1/4			43.81	EK9054	8.72	SK9054	3.35
9054	1/2	4-5/16							
9056	3/4	4-5/16			30.50	EK9052	7.21	SK9052	2.76
9152	9/16-18 SAE	3-1/4							
9153	3/4-16 SAE	3-1/4							



Specifications	
Max. oper. pressure (psi)	3000
Operating temp.(°F)	35 - 200, w/ Viton O-ring: 35 - 400

Hydraulic in-line filters provide protection for small, high pressure systems up to 3,000 psi. By using these filters at the pressure side of a pump, foreign particles 25 microns and larger, such as those created by pump wear, are removed before damage can result. A sintered bronze element ensures protection against crushing should dirt accumulate and increase pressure drop across the element. The unique construction features an anodized aluminum housing for light weight, and a conically shaped sintered bronze element positioned by a retaining spring to allow true, uninterrupted axial flow. Special Viton O-rings are available where chemical compatibility may be a problem. The standard 25 micron element can be easily cleaned or replaced. Nominal filtration ratings of 90, 40, or 10 microns are also available.

FILTERS

Please contact Pennington & Associates for a complete Arrow product line catalog



Part no.	NPT	List price (\$)	Element & seal kit part no.	List price (\$)	Spring kit part no.	List price (\$)
9052T	1/4	48.03	EK9052	7.21	SK9052T	2.75
9053T	3/8					
9152T	9/16 - 18 SAE	55.39				

Tee-type hydraulic in-line filters provide protection for small, high pressure systems up to 5000 psi. Their design is similar to the model 9052 and 9053 filters, with the added convenience of a cleanable element that can be removed without breaking line connections. A filter access cap simply unscrews for easy element cleaning and replacement. The anodized aluminum housing is lightweight, porting is 1/4", 3/8" or 9/16"-18 SAE NPT pipe. Viton O-rings are offered for oil systems where chemical compatibility may be a problem. The standard bronze filter element is 25 micron. Nominal filtration ratings of 90, 40 or 10 microns are available. Overall length: 3-3/16, diameter: 2-1/8, weight: .93 lb.



Specifications	
Max. oper. pressure (psi)	5000
Operating temp. range (°F)	35 - 200, w/ Viton O-ring: 35 - 400

Part no.	NPT	Shut off (scfm)	Weight (lb)	List price (\$)
5074	1/2	85 ± 10	.44	41.87
5076	3/4	100 ± 10	.40	45.06

Specifications	
Max. operating pressure (psi)	300
Max. operating temp. (°F)	160



Air flow check valves are designed to protect workers from accidents caused by air hose whip, a potentially dangerous situation that occurs when air hoses snap while under high pressure loads. When an air hose ruptures, the flow check valve senses an increase in air flow and automatically reduces the flow to a safe level. As a reminder to shut off the air supply before replacing the ruptured hoses, the check valve has an exhaust bleed rate of 9 scfm at 100 psi. These units are easy to install. The inlet pipe port of the check valve is threaded into the supply line, and the air hose is then threaded into the outlet port of the check valve. Overall length: 3-7/8, hex size: 1-1/2.

Part no.	NPT	Overall length	Diameter	Weight (lb)	List price (\$)
602	1/4M x 1/4F	1-3/8	3/4	.15	7.72
602E	5 replacement elements for 602; specify micron rating desired (10, 20, 25, 30, 40)				2.61

Specifications	
Max. operating pressure (psi)	10,000
Operating temp. range (°F)	35 - 300



Pressure snubbers protect instruments from sudden shock and ensure accurate gauge readings without surges and fluctuations. They incorporate a brass housing, a porous bronze element, and are capable of handling pressures to 10,000 psi max. They can also serve as an excellent mini in-line filter. Dry seal pipe threads are standard; SAE available upon special request. Each unit is packaged with five elements of different micron ratings to allow each user to adjust snubbing capacity for the specific application. Low cost and design for quick and simple change of elements make cleaning unnecessary.

Part no.	NPT	Overall length	Hex size	Weight (lb)	List price (\$)
ASP3101-40	1/8	1-1/4	7/16	.04	7.36
ASP3101-90	1/8	1-1/4	7/16	.04	7.36
ASP3102-40	1/4	1-1/2	9/16	.08	8.85
ASP3102-90	1/4	1-1/2	9/16	.08	8.85
ASP3103-40	3/8	1-3/4	11/16	.14	8.85
ASP3103-90	3/8	1-3/4	11/16	.14	8.85
ASP3104-40	1/2	2	7/8	.86	11.70
ASP3104-90	1/2	2	7/8	.86	11.70

In-line nipple filters are inexpensive, disposable, and ideal for the filtration of water, oil, and air. They are compact and lightweight and can be installed at the point of use. Unique unit construction features a brass fitting that contains a conically shaped, porous sintered bronze filter element. The shape of the filter element is conical, rather than disc, to provide a large filtering flow and a true, uninterrupted axial flow. The porous sintered bronze element is available in the nominal filtration rating of 40 or 90 microns to insure minimum pressure drop.

Specifications	
Max. operating pressure (psi)	300
Operating temp. range (°F)	35 - 300



NEW * Alpha Series | Coalescing Filters

Walker Part Number	Connection Size	Flow SCFM**	List Price	Element	List Price
A30006*	1/8"	6	\$145.00	E30306*	\$52.00
A30015*	1/4"	15	\$170.00	E30306*	\$52.00
A30025*	1/4"	25	\$225.00	E30408*	\$90.00
A30032*	3/8"	32	\$250.00	E30408*	\$90.00
A30050*	1/2"	50	\$300.00	E30412*	\$114.00
A30070*	1/2"	70	\$340.00	E30612*	\$160.00
A30085*	3/4"	85	\$400.00	E30612*	\$160.00
A30105*	1"	105	\$430.00	E30612*	\$160.00
A30125*	3/4"	125	\$485.00	E30621*	\$185.00
A30175*	1"	175	\$565.00	E30621*	\$185.00
A30280*	1-1/4"	280	\$800.00	E30731*	\$230.00
A30320*	1-1/2"	320	\$885.00	E30731*	\$230.00
A30400*	1-1/2"	400	\$980.00	E30831*	\$295.00
A30450*	2"	450	\$1,025.00	E30831*	\$295.00
A30700*	2"	700	\$1,360.00	E30850*	\$380.00
A30850*	2-1/2"	850	\$1,495.00	E31140*	\$450.00
A30900*	3"	900	\$1,615.00	E31140*	\$450.00
A31250*	3"	1250	\$1,945.00	E31160*	\$600.00
A31500*	3"	1500	\$2,340.00	E31175*	\$690.00

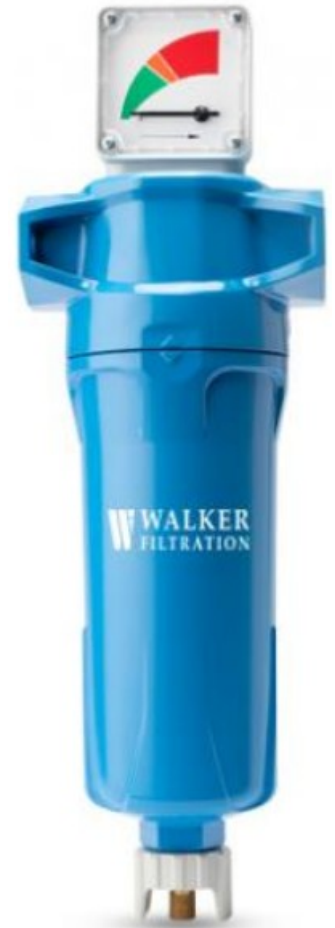

NEW * Alpha Series | Water Separators

Walker Part Number	Connection Size	Flow SCFM	List Price
A30006WS	1/8"	6	\$98.00
A30015WS	1/4"	15	\$118.00
A30025WS	1/4"	25	\$145.00
A30032WS	3/8"	35	\$175.00
A30050WS	1/2"	50	\$205.00
A30070WS	1/2"	70	\$245.00
A30125WS	3/4"	125	\$288.00
A30175WS	1"	175	\$330.00
A30280WS	1 1/4"	280	\$385.00
A30320WS	1 1/2"	320	\$430.00
A30400WS	1 1/2"	400	\$494.00
A30700WS	2"	700	\$590.00
A31500WS	3"	1500	\$1235.00



WALKER FILTRATION PRODUCTS

PRO XF Water Separator | PRICES

PRO XF Water Separators			
Housing Model Number	Connec-tion Size	Flow SCFM	List Price
XF200WS	2"	700	\$1,380.00
XF250WS	2 ½"	850	\$1,380.00
XF300WS	3"	1500	\$1,380.00
XF300FWS	3" flanged	1500	\$1,965.00
XF400FWS	4" flanged	3000	\$2,970.00



Compressed Air Heater and Filter Heater Packages

Heater and Filter Heater Packages				Replacement Elements	
Filter Model	Pipe Size	Flow Rate SCFM	Price	Element Model	Price
A39BH	¾"	27	\$1,055.00	-	N/A
A39FH	¾"	27	\$1,265.00	E511XA	\$124.00
A39TH	¾"	27	\$1,225.00	-	N/A
A39FTH	¾"	27	\$1,430.00	E511XA	\$124.00
A55BH	½"	27	\$1,295.00	-	N/A
A55FH	½"	27	\$1,710.00	E511XA	\$124.00
A55TH	½"	27	\$1,495.00	-	N/A
A55FTH	½"	27	\$1,905.00	E511XA	\$124.00

All dimensions & pipe sizes are in inches

Walker Pro SFD | PD1 Dryers

Dryers				
Dryer Model Number	Connection Size	Flow SCFM	Weight lbs	Price
PD004N	3/8"	4	29	\$1,650.00
PD006N	3/8"	6	31	\$1,760.00
PD008N	3/8"	8	33	\$1,900.00
PD010N	3/8"	10	36	\$2,110.00
PD015N	3/8"	15	43	\$2,525.00
PD025N	3/8"	25	53	\$3,600.00
PD035N	3/8"	35	68	\$4,065.00

Walker Pro SFD | PD2 Dryers

Dryers				
Dryer Model Number	Connection Size	Flow SCFM	Weight lbs	Price
PD045N	3/4"	45	117	\$4,375.00
PD055N	3/4"	55	130	\$4,635.00
PD065N	3/4"	65	141	\$4,840.00
PD085N	1"	85	165	\$5,410.00
PD105N	1"	105	200	\$7,210.00
PD135N	1 1/4"	135	225	\$7,620.00
PD175N	1 1/4"	175	271	\$8,550.00
PD215N	1 1/2"	215	379	\$9,165.00
PD275N	1 1/2"	275	423	\$10,040.00
PD365N	1 1/2"	365	511	\$11,640.00



STAINLESS STEEL BRAIDED HOSES WITH CARBON STEEL MALE PIPE ENDS

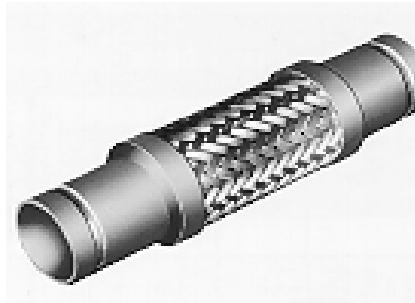

Part no.	Fitting size X length	List price (\$)	1 - 3	4 - 11	12 +
MCS5012	1/2 X 12	62.00	33.48	29.14	26.66
MCS5018	1/2 X 18	66.00	35.64	31.02	28.38
MCS5024	1/2 X 24	71.00	38.34	33.37	30.53
MCS7512	3/4 X 12	83.00	44.82	39.01	35.69
MCS7518	3/4 X 18	91.00	49.14	42.77	39.13
MCS7524	3/4 X 24	98.00	52.92	46.06	42.14
MCS1012	1 X 12	104.00	56.16	48.88	44.72
MCS1018	1 X 18	113.00	61.02	53.11	48.59
MCS1024	1 X 24	122.00	65.88	57.34	52.46
MCS1212	1-1/4 X 12	124.00	66.96	58.28	53.32
MCS1218	1-1/4 X 18	136.00	73.44	63.92	58.48
MCS1224	1-1/4 X 24	148.00	79.92	69.56	63.64
MCS1512	1-1/2 X 12	139.00	75.06	65.33	59.77
MCS1518	1-1/2 X 18	152.00	82.08	71.44	65.36
MCS1524	1-1/2 X 24	166.00	89.64	78.02	71.38
MCS2012	2 X 12	168.00	90.72	78.96	72.24
MCS2018	2 X 18	185.00	99.90	86.95	79.55
MCS2024	2 X 24	202.00	109.08	94.94	86.86
MCS2512	2-1/2 X 12	224.00	120.96	105.28	96.32
MCS2518	2-1/2 X 18	245.00	132.30	115.15	105.35
MCS2524	2-1/2 X 24	265.00	143.10	124.55	113.95
MCS3012	3 X 12	270.00	145.80	126.90	116.10
MCS3018	3 X 18	293.00	158.22	137.71	125.99
MCS3024	3 X 24	316.00	170.64	148.52	135.88

STAINLESS STEEL BRAIDED HOSES WITH STAINLESS STEEL MALE PIPE ENDS

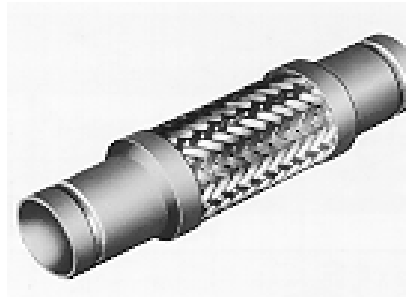

Part no.	Fitting size X length	List price (\$)	1 - 3	4 - 11	12 +
MSS5012	1/2 X 12	73.00	39.42	34.31	31.39
MSS5018	1/2 X 18	77.00	41.58	36.19	33.11
MSS5024	1/2 X 24	82.00	44.28	38.54	35.26
MSS7512	3/4 X 12	95.00	51.30	44.65	40.85
MSS7518	3/4 X 18	103.00	55.62	48.41	44.29
MSS7524	3/4 X 24	110.00	59.40	51.70	47.30
MSS1012	1 X 12	114.00	61.56	53.58	49.02
MSS1018	1 X 18	122.00	65.88	57.34	52.46
MSS1024	1 X 24	131.00	70.74	61.57	56.33
MSS1212	1-1/4 X 12	147.00	79.38	69.09	63.21
MSS1218	1-1/4 X 18	159.00	85.86	74.73	68.37
MSS1224	1-1/4 X 24	171.00	92.34	80.37	73.53
MSS1512	1-1/2 X 12	165.00	89.10	77.55	70.95
MSS1518	1-1/2 X 18	178.00	96.12	83.66	76.54
MSS1524	1-1/2 X 24	192.00	103.68	90.24	82.56
MSS2012	2 X 12	202.00	109.08	94.94	86.86
MSS2018	2 X 18	219.00	118.26	102.93	94.17
MSS2024	2 X 24	236.00	127.44	110.92	101.48
MSS2512	2-1/2 X 12	282.00	152.28	132.54	121.26
MSS2518	2-1/2 X 18	303.00	163.62	142.41	130.29
MSS2524	2-1/2 X 24	323.00	174.42	151.81	138.89
MSS3012	3 X 12	363.00	196.02	170.61	156.09
MSS3018	3 X 18	376.00	203.04	176.72	161.68
MSS3024	3 X 24	399.00	215.46	187.53	171.57

AUTOMATIC ELECTRONIC DRAINS

Part no.	NPT	List price (\$)	1-24	25-49	50
5702S	1/4	241.80	Arrow Pneumatic discounts apply		
5704S	1/2	308.30			
5802 (EAD-25)	1/4	120.00	64.80	56.40	51.60
5803 (EAD-33)	3/8	125.00	67.50	58.75	53.75
5804 (EAD-50)	1/2				

These timer-controlled drains are available in 115 or 230VAC, and offer true installation simplicity at the lowest possible cost. Use of a strainer is recommended to prevent clogging (see page 23). 5700 series includes Y-strainers and have Buna-N seals. Viton seals standard on others. Max. system pressure: 5700 series - 200 psi; 5800 series - 230 psi.



5802



OPTIMUM

Part no.	NPT	List price (\$)	1-24	25-49	50
OPT-25	1/4	130.00	70.20	61.10	55.90
OPT-33	3/8				
OPT-50	1/2				

The Optimum consists of an electronic timer coupled to a solenoid valve. Available for 24VDC/AC, 115VAC, or 230VAC operation, as well as stainless steel and high pressure models. Suitable for all compressed air system components (aftercoolers, dryers, filters, pressure vessels and piping), regardless of their size or capacity. Max. system pressure: 230 psi.



SMART GUARD

Part no.	NPT	List price (\$)	1-24	25-49	50
3623-U3	1/2	495.00	267.30	232.65	212.85

A compact electronically-operated level-sensed condensate drain that offers a zero air-loss solution during the condensate discharge cycle. It can be installed in all compressed air systems with flows up to 3500 cfm. The design features new LED indication of condensate level, a robust, industrial housing, alarm function, and a 2/2 way direct-acting valve assembly. Max. operating pressure: 230 psi. Model shown is 115VAC, normally open alarm mode; call for other voltage, mode, and DC versions.



Private labeling (company name, logo, phone number) is available on some timer drain models. Please call for pricing.

SMART GUARD MINI

Part no.	NPT	List price (\$)	1-24	25-49	50
3622	1/2	250.00	135.00	117.50	107.50

Efficient condensate removal in an extremely small and lightweight package. Perfect for systems with flows up to 350 cfm. Includes a test button, LED indicator light, an externally mounted valve, and removable electronic module and top cover, allowing the drain to be easily disassembled without disconnecting pipe work. Integrated mesh strainer to protect valve. An internal sensor automatically detects potential blockages and will pulsate the valve in attempt to clear them. Max. operating pressure: 230 psi. Model shown is 115VAC; call for DC and other voltage versions.



SMART GUARD HP

Part no.	NPT	List price (\$)	1-24	25-49	50
3623-H1	1/2	1350.00	729.00	634.50	580.50

Features a remote alarm contact, test button, LED indicator lights, and an optional heater for cold weather applications. Robust 2/2-way capacitive level sensor operates a direct acting valve to discharge condensate without losing valuable compressed air. Includes six foot power cord and a removable electronic module and top cover, allowing disassembly without disconnecting pipe work. Max. pressure: 725 psi. Max. flow: 3500 CFM. Model shown is 115VAC, normally open alarm mode; call for other voltage, mode, and DC versions.



TEC-44 motorized ball valve series

Part no.	NPT	List price (\$)	1-24	25-49	50
TEC-44-1/2	1/2	403.00	217.62	189.41	173.29
TEC-44-3/4	3/4	480.00	259.20	225.60	206.40
TEC-44-1	1	575.00	310.50	270.25	247.25

The TEC-44 incorporates a micro processor which ensures that all those heavily contaminated systems get drained on time, every time. For heavy duty applications. Units for AC operation shown; DC units available.



TEC-11 drain for filter series

Part no.	NPT	List price (\$)	1-24	25-49	50
TEC-11-18	1/8	130.00	70.20	61.10	55.90
TEC-11-14	1/4				

The TEC-11 is designed to drain condensate from all compressed air filters, regardless of filter capacity. The in-line design allows for fast efficient installation. A range of fast-fit adapters, which can be matched to any model/brand or type of filter, is available.



MECHANICAL (NON-ELECTRIC) DRAINS

SMART GUARD POD-TD



Part no.	NPT	List price (\$)	1-24	25-49	50
3805	1/2	307.00	165.78	144.29	132.01

Designed specifically for applications where electricity is difficult to provide, this drain provides effective condensate removal yet requires no electrical power. Good for systems with flows up to 3500 cfm. A newly developed 3/2-way level controlled valve principle operates a direct cylinder valve, discharging the condensate automatically from your system. There is no unnecessary compressed air lost during this process. Pressure range: 44-230 psi.



MAG-11

Part no.	NPT	List price (\$)	1-24	25-49	50+
MAG-11	1/2 in - 1/8 out	210.00	113.40	98.70	90.30

The MAG-11 is designed to remove condensate from compressed air filters. A float in the unit's reservoir rises as the condensate collects, and once the 8 oz capacity is reached the valve opens. When the condensate finishes draining, an internal magnet closes the valve. It is therefore ideally suited to applications where power is not available. No timers to set or plug in. Operation is automatic and without waste of valuable compressed air. Max. system pressure: 230 psi.



Mini MAG

Part no.	NPT	List price (\$)	1-24	25-49	50+
Mini MAG	1/2 in - 1/8 out	150.00	81.00	70.50	64.50

A compact version of the MAG-11 for tight installations. Max. system pressure: 230 psi.



CDI Next Generation

Part no.	List price (\$)	1-24	25-49	50+
EH38-0LAAA	259.00	139.86	121.73	111.37

Ideal for compressor applications up to 25HP (100 SCFM). Avoids blockage common to small passages in other designs, and eliminates the need for timer drains. Auto adjusts to required flow without any type of manual input. Max. system pressure: 200 psi, min. operating pressure: 40 psi, Max flow @ 100 psi: 0.2 gpm, Temp. range: 34°-170°F, Wt.:7lbs, Inlet/outlet connections: 3/8NPT, Height: 7.2 in.



CDI/DRAIN-ALL Condensate Traps

Part no.	Model	List price (\$)
DH50-0LAAA	Condensate Handler	942.22
LH50-0LAAA	WaterHog	366.85
PH50-0LAAA	Pressure Handler	1112.89
RH50-0LAAA	Rust Handler	978.25



Drain-All's extensive line of patented "zero-loss" condensate traps contribute energy-saving, performance-improving functionality to many compressed air and compressed gas system applications. Drain-All's Condensate Handler has become an industry standard for purging water from compressed air systems in a highly efficient and energy-saving way, and the same patented design has been modified to accommodate a variety of non-standard applications including high and low-pressure environments, high temperatures, and high concentrations of rust or other solids.

PRESSURE SWITCHES

Part no.	Fixed unloader position	Auto on/off	No. of ports	Factory setting (psi)	Square D & Furnace crossover	List price (\$)	1-4	5-24	24+
SW35-59	N/A	N/A	1	65-110	FHG-2J27	35.87	19.37	16.86	15.42
SW35-60	B	T	1	90-125	FHG-12J52X	37.98	20.51	17.85	16.33
SW35-61	B	T	4	90-125	FHG-14J52MIX	N/A	DISCONTINUED		
SW35-62	S	S	4	90-125	69MB7LY2C	40.51	21.88	19.04	17.42
SW35-63	B	T	1	115-150	N/A		DISCONTINUED		
SW35-64	B	T	4	115-150	N/A		DISCONTINUED		
SW35-65	S	S	4	115-150	69MB8LY2C	40.51	21.88	19.04	17.42
SW35-66	S	T	1	95-125	69MB7LY	41.34	22.32	19.43	17.78
SW35-67	S	T	1	115-150	69MB8LY	41.34	22.32	19.43	17.78
SW35-70	B	N/A	1	140-175	N/A	N/A	DISCONTINUED		
SW35-71	N/A	N/A	1	140-175	FHG-52J59	N/A	DISCONTINUED		
SW35-72	B	N/A	4	140-175	FHG-52J59X	37.98	20.51	17.85	16.33
SW35-73	S	N/A	1	140-175	69MB9X	41.54	22.43	19.52	17.86
SW35-74	S	N/A	4	140-175	69MB92YC	41.54	22.43	19.52	17.86
B=Bottom, T=Top, S=Side									
Pressure switches are rated 1-1/2 HP @115V, 3HP @230V									



PRESSURE/VACUUM GAUGES - PRICING

On the following pages you will find our extensive lineup of pressure/vacuum gauges. Please order using the numbering system on the facing page. If you do not find a suitable style, customer service will be happy to assist you. The following variations are available:

DRY

- Steel case with chrome ring & brass internals
- Available in 1-1/2", 2", 2-1/2", 3-1/2", and 4-1/2" diameters
- 30 psi to 15,000 psi
- Bottom or back mount
- Connection: 1/8"NPT on 1-1/2" dial gauges, 1/4" on all others

LIQUID-FILLED

- Stainless steel case with brass internals and glycerine fill
- Available in 1-1/2", 2", 2-1/2", 4", and 6" diameters
- Vacuum or vacuum/pressure, 30 psi to 15,000 psi
- Bottom or back mount, flanges, & U-clamps
- Connection: 1/8"NPT on 1-1/2" & 2" dials, 1/4"NPT on 2-1/2" & 4", 1/2"NPT on 4" & 6"

TO ORDER

SPECIFY

1. Diameter: 1-1/2", 2", 2-1/2", 3-1/2", 4", 4-1/2", 6"
2. Pressure range: 0-30, 0-60, etc.
3. Mounting style: bottom or back
4. Connection: 1/8", 1/4", or 1/2" NPT
5. Dry or glycerine filled

DRY	Dial size	List price (\$)	1-49	50-249	250+
	1-1/2", 2"	9.65	5.21	4.54	4.15
	2-1/2"	12.85	6.94	6.04	5.53
	4-1/2"	42.85	23.14	20.14	18.43
LIQUID FILLED	1-1/2", 2", 2-1/2"	34.50	18.63	16.22	14.84
	4"	81.75	44.15	38.42	35.15

PRICES SUBJECT TO CHANGE WITHOUT NOTICE

GAUGE PART NUMBERING SYSTEM

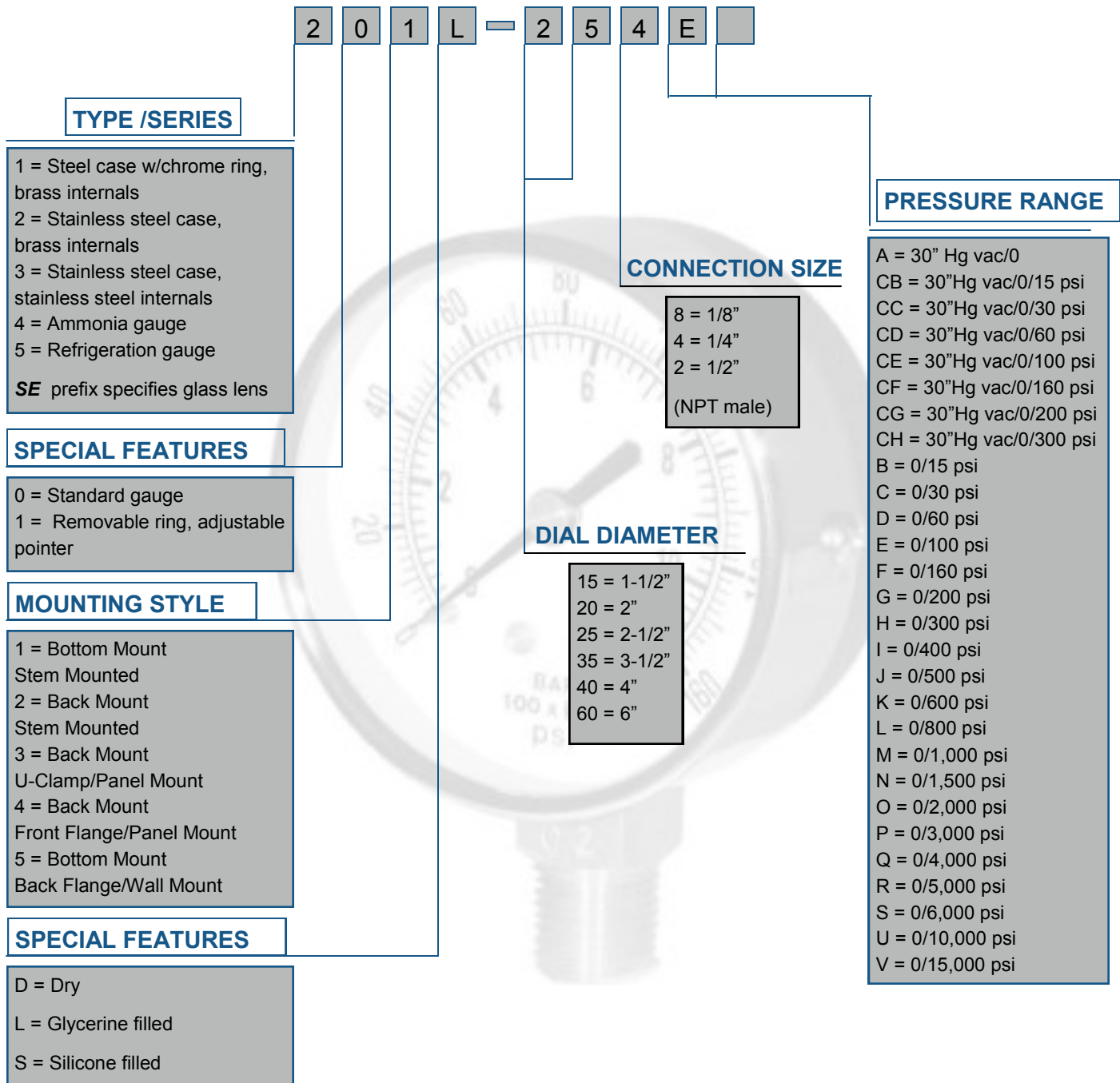

EXAMPLE: 201L-254E - Stainless steel case w/ brass internals, standard gauge, bottom mount stem mounted, glycerine filled, 2-1/2" dial, 1/4" NPT, 0-100 psi

DRY GAUGES

101D Series Bottom Mount

Part no.	Dial diameter	"A"	"B"	"C"	"E"	Port size (NPT)	List price (\$)	1-49	50-249	250+
101D158X*	1-1/2	1.67	.90	.31	1.65	1/8	9.65	5.21	4.54	4.15
101D204X	2	2.08	1.10	.39	1.81	1/8, 1/4				
101D254X	2-1/2	2.49	1.10	.39	2.04	1/4	12.85	6.94	6.04	5.53

*X = Enter pressure range code from gauge part numbering chart

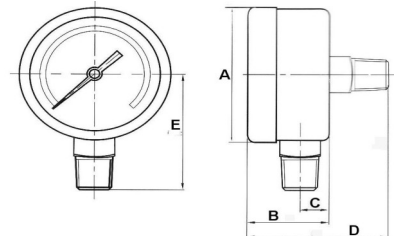

102D Series Center Back Mount

Part no.	Dial diameter	"A"	"B"	"D"	Port size (NPT)	List price (\$)	1-49	50-249	250+
102D158X	1-1/2	1.67	.90	1.65	1/8	9.65	5.21	4.54	4.15
102D204X	2	2.08	1.10	1.85	1/8, 1/4				
102D254X	2-1/2	2.49	1.10	1.85	1/4	12.85	6.94	6.04	5.53
102D454X	4-1/2	3.93	1.10	2.08	1/4	42.85	23.14	20.14	18.43



103D Series U-clamp Mount

Part no.	Dial diameter	"A"	"B"	"C"	"D"	"E" port size (NPT)	"F"	"G"	List price (\$)	1-49	50-249	250+
103D158x	1-1/2	1.67	1.03	.61	1.64	1/8	2.63	1.63	27.00	14.58	12.69	11.61
103D204x	2	2.08	1.17	.73	1.90	1/8, 1/4	2.81	2.00				
103D254x	2-1/2	2.49	1.19	.76	1.95	1/4	3.48	2.50				

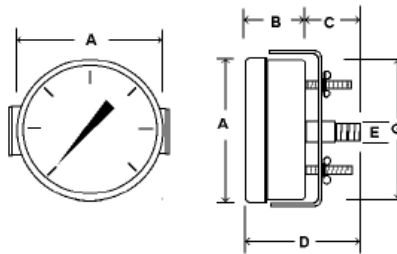

104D Series Panel Mount

Part no.	Dial diameter	"A"	"B"	"C"	"D"	"E" port size (NPT)	"F"	"G"	List price (\$)	1-49	50-249	250+
104D158x	1-1/2	1.67	1.03	.61	1.64	1/8	2.63	1.63	27.00	14.58	12.69	11.61
104D204x	2	2.08	1.17	.73	1.90	1/8, 1/4	2.81	2.00				
104D254x	2-1/2	2.49	1.19	.76	1.95	1/4	3.48	2.50				

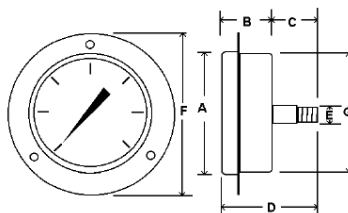

LIQUID-FILLED GAUGES

201L Series Bottom Mount

Part no.	Dial diameter	"A"	"B"	"C"	"E"	Port size (NPT)	List price (\$)	1-49	50-249	250+
201L158x	1-1/2	1.67	.90	.31	1.65	1/8	34.50	18.63	16.22	14.84
201L204x	2	2.08	1.10	.39	1.81	1/8, 1/4				
201L254x	2-1/2	2.49	1.10	.39	2.04	1/4				
201L404x	4	3.93	1.37	.51	2.95	1/4	81.75	44.15	38.42	35.15

*X = Enter pressure range code from gauge part numbering chart

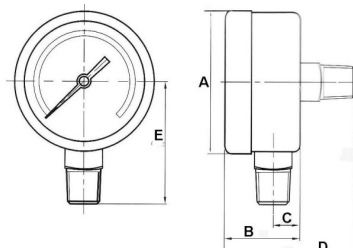

202L Series Center Back Mount

Part no.	Dial diameter	"A"	"B"	"D"	Port size (NPT)	List price (\$)	1-49	50-249	250+
202L158x	1-1/2	1.6	.90	1.65	1/8	34.50	18.63	16.22	14.84
202L204x	2	2.08	1.10	1.85	1/8, 1/4				
202L254x	2-1/2	2.49	1.10	1.85	1/4				
202L404x	4	3.93	1.37	2.08	1/4	81.75	44.15	38.42	35.15



203L Series U-clamp Mount

Part no.	Dial diameter	"A"	"B"	"C"	"D"	"E" port size (NPT)	"F"	"G"	List price (\$)	1-49	50-249	250+
203L158x	1-1/2	1.85	1.02	0.72	1.74	1/8	2.75	1.63	48.50	26.19	22.80	20.86
203L204x	2	2.28	1.18	0.94	2.08	1/8, 1/4	3.13	2.05				
203L254x	2-1/2	2.80	1.34	0.94	2.28	1/4	3.84	2.48	55.95	30.21	26.30	24.06

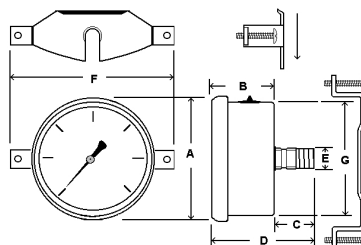

204L Series Panel Mount

Part no.	Dial diameter	"A"	"B"	"C"	"D"	"E" port size (NPT)	"F"	"G"	List price (\$)	1-49	50-249	250+
204L158x	1-1/2	1.85	1.02	0.72	1.74	1/8	2.46	1.63	48.50	26.19	22.80	20.86
204L204x	2	2.28	1.18	0.94	2.08	1/8, 1/4	2.81	2.05				
204L254x	2-1/2	2.80	1.34	0.94	2.28	1/4	3.45	2.48	55.95	30.21	26.30	24.06

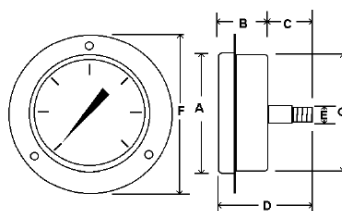

TANK KITS

Part no.	Tank size (gal)	SCFM @ 200 psi	Safety valve thread (NPT)	Net price (\$)
TK12080-*	20-80	178	1/4	40.00
TK12230-*	80-120			45.00
TK12240-*	120-240	358	1/2	60.00
TK12400-*	400-500			80.00
TK66106-*	660-1060	1624	1	110.00
TK15500-*	1500+			140.00

* Indicate desired valve relief pressure setting

All kits include: drain kit fittings, safety valve, manual ball valve, and pressure gauge



Options:

Suffix	Add'l charge
A = 1/4" NPT electric drain with strainer	65.00
4 = 4" 200 psi liquid-filled pressure gauge	35.00
F = T53-04 drain trap	75.00
V1 = (4) 4" anti vibration pads	15.00
V2 = (4) 6" anti vibration pads	25.00
Z = Zero loss drain	230.00
MAG = Magnetic zero loss drain	100.00

TANK KIT ACCESSORIES



-A



-4



-F



-V1 or -V2



-Z

ANTI-VIBRATION PADS CORK & RUBBER

Part no.	List price, each (\$)	1-48	49-96	97+
4x4x1	7.25	3.92	3.41	3.12

Part no.	List price, case of 24 (\$)	1-2	3-4	5+
4x4x1-24	165.60	89.42	77.83	71.21

Part no.	List price, each (\$)	1-48	49-96	97+
6x6x1	12.00	6.48	5.64	5.16

Part no.	List price, case of 12 (\$)	1-4	5-8	9+
6x6x1-12	138.00	74.52	64.86	59.34

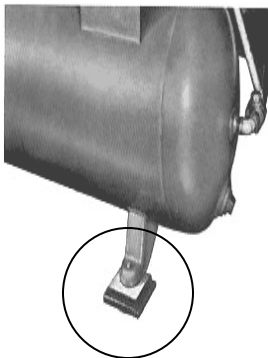
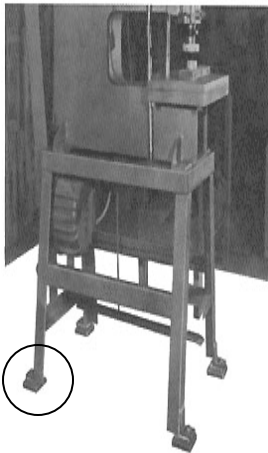

- Highest quality elastomer; oil resistant padding.
- Designed to withstand 50 lbs. per square inch.
- Rubber pads are corrugated on both sides.
- Ideal for air conditioners, compressors, cooling towers, presses, machines, etc.

OIL/WATER SEPARATORS



Part no.	Description	Net price (\$)
9703JA	Puro CT 125 (Synthetic Oils)	345.00
9703JB	Puro CT 125 (Polyglycol Oils)	358.00
9707JA	Puro CT 250 (Synthetic Oils)	535.00
9707JB	Puro CT 250 (Polyglycol Oils)	557.00
9715JA	Puro CT 600 (Synthetic Oils)	998.00
9715JB	Puro CT 600 (Polyglycol Oils)	1021.00

Part no.	Description	Net price (\$)
9602	Sepremium 70 SCFM	170.00
9603-JN	Sepremium 130 SCFM	408.00

Part no.	Description	Net price (\$)
9605-JN	Sepremium 175 SCFM	520.00
9610-JN	Sepremium 350 SCFM	665.00
9620-JN	Sepremium 750 SCFM	1199.00
9630-JN	Sepremium 1250 SCFM	1700.00
9660-JN	Sepremium 2500 SCFM	3400.00

Part no.	Description	Net price (\$)
9605-PG-JN	Sepremium 175 SCFM Polyglycol	535.00
9610-PG-JN	Sepremium 350 SCFM Polyglycol	735.00
9620-PG-JN	Sepremium 750 SCFM Polyglycol	1265.00
9630-PG-JN	Sepremium 1250 SCFM Polyglycol	1820.00
9660-PG-JN	Sepremium 2500 SCFM Polyglycol	3525.00

Part no.	Description	Net price (\$)
9605-JC	Sepremium 175 SCFM RotoInject	535.00
9610-JC	Sepremium 350 SCFM RotoInject	735.00
9620-JC	Sepremium 750 SCFM RotoInject	1265.00
9630-JC	Sepremium 1250 SCFM RotoInject	1820.00
9660-JC	Sepremium 2500 SCFM RotoInject	3525.00

JORC also offers replacement filters for competitor's separators. Call for pricing.

All dimensions & pipe sizes are in inches



ConDePhase®
PLUS
 Oil/Water Separator



ConDePhase® Plus is an oil-water separator built specifically for compressor condensate disposal. The ConDePhase® Plus oil/water separator is simple, automatic and the best economical solution for oily compressor condensate disposal. To add to its ease of use, the ConDePhase® Plus uses gravity separation, which means it doesn't need to be plugged in, has no moving parts, and is virtually maintenance free. Inlet connection is female 1/2 NPT; oil drain is female 3/4 NPT.

Model no.	Part code	Tank capacity (gals)	Dimensions (H x L x W)	Water drain size (female NPT)	Weight (lbs)	Price (\$)
ConDePhase® Plus - 15	349009	15	30-1/4 x 23-1/2 x 11-3/4	3/4	33	1167.00
ConDePhase® Plus - 30	349019	30	34-1/4 x 27-1/2 x 13-3/4	3/4	56	1785.00
ConDePhase® Plus - 80	349024	80	48-1/4 x 31-1/2 x 15-3/4	1	130	3020.00
ConDePhase® Plus - 160	349012	160	52-1/4 x 42-1/2 x 20-3/4	1	170	4081.00
ConDePhase® Plus - 200	349015	200	54 x 48 x 24	1	185	4871.00
ConDePhase® Plus - 300	349018	300	60 x 57 x 28	1	215	6364.00
ConDePhase® Plus - 400	349022	400	72 x 57 x 29	1-1/2	280	7876.00

ConDePhase® Plus Replacement Filters			
Model no.	Part code	Application	Price (\$)
CPF-003	349026	CDP Plus 15	190.00
CPF-005	349027	CDP Plus 30	221.00
CPF-016	349028	CDP Plus 80	574.00
CPF-030	349029	CDP Plus 160, 200, 300	1021.00
CPF-055	349030	CDP Plus 400	1722.00
Expansion chamber	349032	All units	Call for price

DESICCANTS and CLEANERS

ACTIVATED ALUMINA



Standard packaging is 50 lb bag	Bead size			Price (\$) per bag	
	1/8	3/16	1/4	50-950 lbs	1000 lbs +
Part no.	34011	34012	34013	75.00	70.00



- Used primarily for air drying and low temperature applications.
- Three bead sizes available.
- Large porosity and surface area promote efficient air drying.
- Very stable physically and chemically, even in high temperature and corrosive environments.
- Molecular sieve and deliquescent also available; call for pricing.
- Free shipping on 40 bags or more originating from our Broadview, IL facility.

SILICA GEL

SORBEAD® blue silica gel desiccant		
Model no.	Description	List price (\$)
34189	Case of (6) 1-qt jars	149.60
34417	Case of (4) 1-gal jugs	299.80

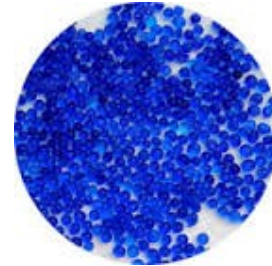

Sublime
Water Scale Solvent



Sublime is the Solution!

Sublime is a water-based solvent enhanced with wetting agents, corrosion inhibitors and degreasing compounds. It is designed to penetrate and remove encrusted lime scale, rust, dirt and corrosion by-products from water-wetted internal surfaces of commercial and industrial processing equipment.

Product	1 gal (6/case)	5 gal pail	30 gal drum	55 gal drum
* Alimex (Descaler)	108.00	86.00	494.00	872.00
* Morcon-10 (Cement Remover)	104.00	82.00	470.00	828.00
* Sublime™ (Descaler)	100.43	79.96	461.56	814.09
* Sum-Kool™ (Descaler)	168.00	136.00	798.00	1428.00
* Sure-Clean (Industrial Degreaser)	86.86	68.57	389.71	683.43
* XTRA-Clean (Industrial Degreaser)	98.00	78.00	448.00	788.00

SAFETY RELIEF VALVES FLOW CAPACITY CHART

	CDI series	ST	SF	SB	SW
	NPT	1/8, 1/4 ,3/8	1/2	1/2, 3/4	1 & 1-1/4
		SCFM			
P S I	40	45	90	194	406
	60	61	123	267	558
	70	70	140	305	635
	75	74	148	322	673
	90	86	174	376	787
	100	95	190	412	863
	110	103	207	449	939
	125	116	232	504	1053
	135	124	249	540	1129
	140	128	257	558	1167
	150	136	274	595	1244
	165	149	299	649	1357
	175	157	316	686	1434
	190	170	341	740	1548
	200	178	358	777	1624
	210	186	375	814	1700
	225	199	400	868	1814
	240	212	425	922	1929
	250	220	442	959	2005
	260	228	467	995	2081
	275	241	491	1032	2195
	300	262	534	1141	2385
	325	282	N/A	N/A	N/A
	350	303	N/A	N/A	N/A

See pages 4 - 7 for ordering information.

Kunkle Series 6000 Industrial Safety Valves flow chart (scfm)

Pressure setting (psig)	Order code and orifice size (in ²)					
	D (.121)	E (.216)	F (.338)	G (.554)	H (.863)	J (1.414)
25	83	149	232	381	594	976
30	93	166	259	425	664	1090
35	104	185	289	474	740	1216
40	115	204	319	524	817	1341
50	136	243	379	622	970	1593
60	158	281	439	720	1123	1844
70	179	319	498	818	1276	2095
75	190	339	528	867	1353	2221
80	201	358	558	916	1429	2347
90	222	396	618	1014	1582	2598
100	244	434	678	1112	1735	2849
110	265	473	738	1210	1888	3101
115	276	492	768	1259	1965	3226
120	287	511	797	1308	2041	3352
125	297	530	827	1357	2118	3478
130	308	549	857	1406	2194	3603
135	319	568	887	1455	2271	3729
140	330	588	917	1505	2347	3855
145	340	607	947	1554	2424	3980
150	351	626	977	1603	2501	4106
160	372	664	1037	1701	2654	4357
170	394	702	1096	1799	2807	4609
180	415	741	1156	1897	2960	4860
190	437	779	1216	1995	3113	5111
200	458	817	1276	2093	3266	5365
210	480	856	1336	2191	3419	5614
220	501	894	1395	2289	3572	5865
230	523	932	1455	2387	3725	6117
240	544	971	1515	2486	3878	6368
250	566	1009	1575	2584	4031	6619
260	587	1047	1635	2682	4184	6817
270	609	1086	1694	2780	4337	7122
280	630	1124	1754	2878	4490	7373
290	652	1162	1814	2976	4643	7625
300	673	1200	1874	3074	4796	7876

See page 18 for ordering information.

Compressed air systems can accumulate as much as **30 gal** of water **a day!** Use the chart below to estimate your system's output. Then check out our complete line of mechanical and electronic drains on pages 36 thru 38 to help you get rid of it.

Basics of Compressed Air

At 100 psig, an air compressor compresses eight cubic feet of air into one cubic foot.

The water vapor, dust, dirt and odors in the air cause the following problems in compressed air systems:

- Paint defects or fish eye
- Rust and pipe scale
- Damages machinery
- Creates air line freezes
- Shortens air tool or equipment life
- Reduces air flow

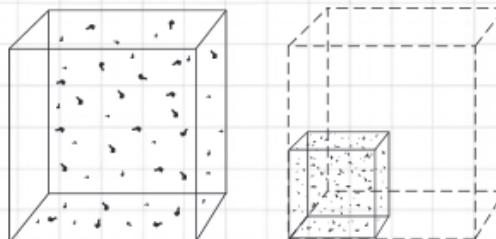

When compressed to 100 psig, the air becomes 1/8 its previous size. The volume of air has changed, but the amount of water, vapor, dust, dirt and odors has not changed but just become more concentrated.

Water Factor Chart

Follow the steps below to determine the gallons of water accumulated by a compressed air system per 8 hours of use:

- 1** Determine the ambient temperature (outside temperature surrounding the dryer) and relative humidity.
- 2** Locate ambient temperature in first column of water factor chart.
- 3** Follow the row over to percent of humidity. This indicates the number of gallons accumulated by your air compressor in an 8-hour period.

EXAMPLE

25 HP air compressor delivers 100 scfm.

Ambient Temperature = 100° F

Relative Humidity = 60%

Water factor chart number is 31.2

Compressed air system accumulates 31.2 gallons of water per 8 hours of use.

Gallons of Water Per 8 Hours @ 100 SCFM

Ambient Air Temperature	20% Humidity	30% Humidity	40% Humidity	50% Humidity	60% Humidity	70% Humidity	80% Humidity	90% Humidity	100% Humidity
120° F	18.6	27.9	37.2	46.5	55.8	65.1	74.4	83.7	93.0
110° F	14.1	21.0	27.9	35.1	42.0	48.9	55.8	63.0	69.9
100° F	10.5	15.6	20.7	26.1	31.2	36.6	41.7	46.8	52.2
90° F	7.8	11.4	15.3	19.2	23.1	26.7	30.6	34.5	38.4
80° F	5.7	8.4	11.1	13.8	16.8	19.5	22.2	24.9	27.9
70° F	3.9	6.0	7.8	9.9	12.0	13.8	15.9	18.0	19.8
60° F	2.7	4.2	5.7	6.9	8.4	9.9	11.1	12.6	14.1
50° F	2.1	3.0	3.9	4.8	6.0	6.9	7.8	8.7	9.9
40° F	1.2	2.1	2.7	3.3	3.9	4.8	5.4	6.0	6.6
30° F	.9	1.2	1.8	2.1	2.7	3.0	3.6	3.9	4.5
20° F	.6	.9	1.2	1.5	1.7	1.9	2.1	2.4	2.7

PENNINGTON & ASSOCIATES

TERMS & RETURN POLICY

TERMS:

- Completed credit applications are required for all new accounts.
- \$25.00 minimum order.
- Master Card, Visa, and American Express accepted.
- Open accounts are net 30 days.
- Unless otherwise requested, orders are shipped FedEx Ground. UPS, motor freight, collect, and third party billing available.
- A handling fee will be charged on all UPS and FedEx orders.
- Products shown in catalog are not guaranteed for a particular purpose and are warranted by the manufacturer.
- Prices are subject to change without notice.
- Fax or email a copy of your tax exempt certificate or ID to qualify for tax-exempt status.

RETURN POLICY:

- It is the customer's responsibility to inspect all packages for damage before signing delivery receipt.
- Pennington & Associates will only accept returns with prior authorization. Call or email us to obtain a Return Goods Authorization (RGA) number. The RGA number will be valid for 30 days only. The following information must also accompany the package upon return:
 - Original Invoice #
 - Date of purchase
 - Your PO #
 - Reason for return
 - Pennington & Associates Authorized RGA #
- Returns to Pennington & Associates or the manufacturer must be shipped UPS or freight prepaid. Units received at Pennington & Associates shipped freight collect or without RGA information will be refused and returned at customer's expense.
- Items must be returned in original packaging and in re-sellable condition. If they are found to be defective, the items will be replaced or a credit issued according to the terms of the manufacturer's warranty.
- Returns of non-defective products will be subject to a 25% re-stocking charge.
- Overshipments or incorrect shipments must be returned freight prepaid after an RGA is issued. We will credit your freight cost.
- Warranty replacement parts in stock at our Clearwater warehouse will be shipped FOB Clearwater, FL.

This symbol identifies products proudly made by our suppliers in the USA.
All items on the same page are American-made.



Pennington & Associates, a woman-owned business, is proud to be an Earth-friendly supplier. We recycle packaging containers and packing material as much as possible, and encourage our employees to recycle all aluminum cans, paper, cardboard, and plastic. Our hazardous waste (electronics, fluorescent tubes, batteries, chemicals) is removed to an off-site facility for proper disposal.



PENNINGTON
& ASSOCIATES

14300 60th Street North
Clearwater, FL 33760

Phone 727.535.3200
Fax 727.533.9696

email: sales@penningtonassociates.com
penningtonassociates.com

**Your go-to compressed air supplier
for over 30 years.**

2021